

COMPONENTS OF CONTRACT PLANS SET  
ROADWAY PLANS

A DETAILED INDEX APPEARS ON THE  
KEY SHEET OF EACH COMPONENT

INDEX OF ROADWAY PLANS

SHEET NO.	SHEET DESCRIPTION
1	KEY SHEET
2	SUMMARY OF PAY ITEMS
3	TYPICAL SECTIONS
4	PROJECT LAYOUT AND CONTROL
5	GENERAL NOTES
6 - 9	PLAN SHEETS
10 - 11	PROFILE SHEETS BACK OF SIDEWALK
12	SPECIAL DETAILS
13 - 25	CROSS SECTIONS
26	STORMWATER POLLUTION PREVENTION PLAN
SQ-1 - SQ-5	SUMMARY OF QUANTITIES

GOVERNING STANDARD PLANS:

Florida Department of Transportation, FY2023-24 Standard Plans for Road and Bridge Construction and applicable Interim Revisions (IRs).

Standard Plans for Road Construction and associated IRs are available at the following website: <http://www.fdot.gov/design/standardplans>

GOVERNING STANDARD SPECIFICATIONS:

Florida Department of Transportation, FY 2023-24 Standard Specifications for Road and Bridge Construction at the following website: <http://www.fdot.gov/programmanagement/Implemented/SpecBooks>

BOARD OF COUNTY COMMISSIONERS

BOB DALLARI	DISTRICT 1
JAY ZEMBOWER	DISTRICT 2
LEE CONSTANTINE	DISTRICT 3
AMY LOCKHART	DISTRICT 4
ANDRIA HERR	DISTRICT 5

DARREN GRAY , COUNTY MANAGER

SEMINOLE COUNTY  
ENGINEERING DIVISION

CONTRACT PLANS



ORANOLE WAY & LINNEAL BEACH DR. SIDEWALK  
SEMINOLE COUNTY CIP No. 02207081

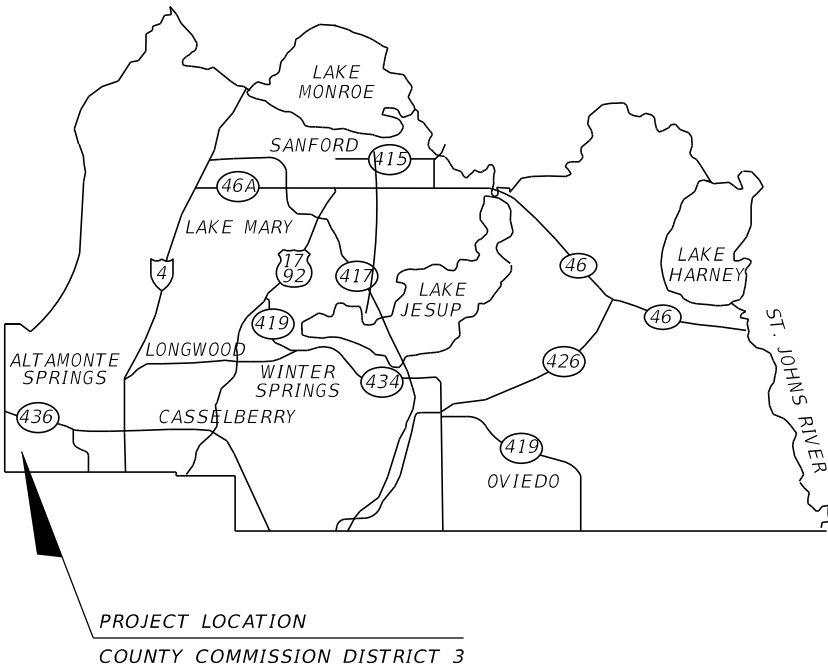
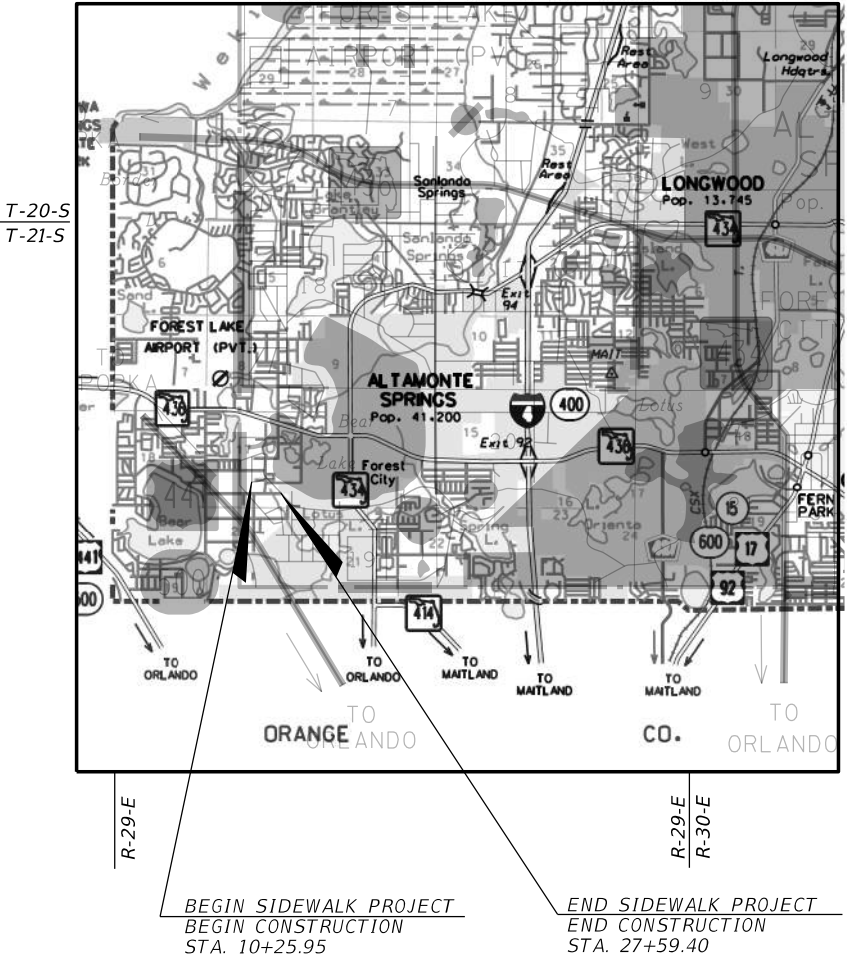

ROADWAY PLANS  
ENGINEER OF RECORD:

DINO E. LUCARELLI, P.E. NO. 39556  
SEMINOLE COUNTY PUBLIC WORKS ENGINEERING  
100 E FIRST STREET  
SANFORD, FL 32771  
(407) 665-5661

COUNTY PROJECT MANAGER:

DINO E. LUCARELLI, P.E.

PUBLIC WORKS DIRECTOR: JEAN JREIJ, P.E.

FISCAL YEAR	SHEET NO.
23	1

SUMMARY OF PAY ITEMS			
PAY ITEM NO.	PAY ITEM DESCRIPTION	UNIT	QUANTITY
101-1	MOBILIZATION	LS	1
102-1	MAINTENANCE OF TRAFFIC	LS	1
102-99	CHANGEABLE VARIABLE MESSAGE SIGN (TEMPORARY)	ED	60
104-10-3	SEDIMENT BARRIER	LF	1476
110-1-1	CLEARING AND GRUBBING	LS	1
110-4-10	REMOVAL OF EXISTING CONCRETE	SY	163
110-7-2	MAILBOX, RELOCATE EXISTING, STANDARD, SINGLE	EA	2
120-1	REGULAR EXCAVATION	CY	329.9
120-6	EMBANKMENT	CY	129.8
400-0-11	CONCRETE CLASS NS, GRAVITY WALL	CY	65.5
430-175-118-A	CONCRETE PIPE CULVERT, S/CD, CLASS III, 18"	LF	6
430-982-125-A	MITERED END SECTION, CD, CONCRETE PIPE ROUND, CLASS III, 18"	EA	1
515-1-2	PIPE HANDRAIL - GUIDERAIL, ALUMINUM, F&I	LF	531
520-1-10	CONCRETE CURB & GUTTER, TYPE F	LF	21
522-1	SIDEWALK AND DRIVEWAYS, (CONCRETE) (4" THICK)	SY	818
522-2	SIDEWALK AND DRIVEWAYS, (CONCRETE) (6" THICK)	SY	158
527-2	DETECTABLE WARNINGS (PERFORMED THERMOPLASTIC)	SF	41
570-1-2	PERFORMANCE TURF, SOD	SY	1640
700-1-50	SINGLE POST SIGN, RELOCATED	AS	7
711-11-125	THERMOPLASTIC PAVT MARKINGS, STD, WHITE SOLID, 24" (STOP LINE/CROSSWALK)	LF	222

- 102-1

INCLUDES ALL ITEMS AND LABOR NECESSARY FOR THE IMPLEMENTATION OF THE TRAFFIC CONTROL PLAN DESIGNED BY THE CONTRACTOR AND APPROVED BY SEMINOLE COUNTY ENGINEERING. THE CONTRACTOR SHALL NOTIFY SURROUNDING RESIDENCES AND BUSINESSES OF THE CONSTRUCTION BY FLYER PROVIDED BY SEMINOLE COUNTY.
- 102-99

INCLUDES COST FOR 2 PCMS TO BE SET-UP 7 DAYS PRIOR TO CONSTRUCTION. CONTRACTOR TO COORDINATE LOCATION WITH SEMINOLE COUNTY PROJECT MANAGER.
- 110-1-1

INCLUDES THE COST OF REMOVAL AND DISPOSAL OF ALL OBSTRUCTIONS, VEGETATION, DEBRIS, TRIMMING OF TREES AND SHRUBS, ROOT REMOVAL, WALL, FENCES, DRAIN FIELDS PIPE, PAVEMENT, AND OTHER ITEMS, IN ORDER TO CONSTRUCT THE PROJECT. NO TREES ARE TO BE REMOVED WITHOUT THE APPROVAL FROM THE SEMINOLE COUNTY PROJECT MANAGER. ALSO INCLUDES THE CUTS FOR SAWCUTTING EXISTING PAVEMENT OR CONCRETE AND TREE PROTECTION BARRICADES.
- 570-1-2

INCLUDES THE COST AND APPLICATION OF FERTILIZER AND WATER IN ACCORDANCE WITH THE STANDARD SPECIFICATIONS. INCLUDES THE COST OF SOD TO BE PLACED AS DIRECTED BY THE PROJECT MANAGER. TYPES OF SOD MAY VARY, CONTRACTOR TO MATCH EXISTING SOD. AN ADDITIONAL 148 SY OF SOD IS ADDED, TO BE ALLOCATED FOR FIELD ADJUSTMENTS.

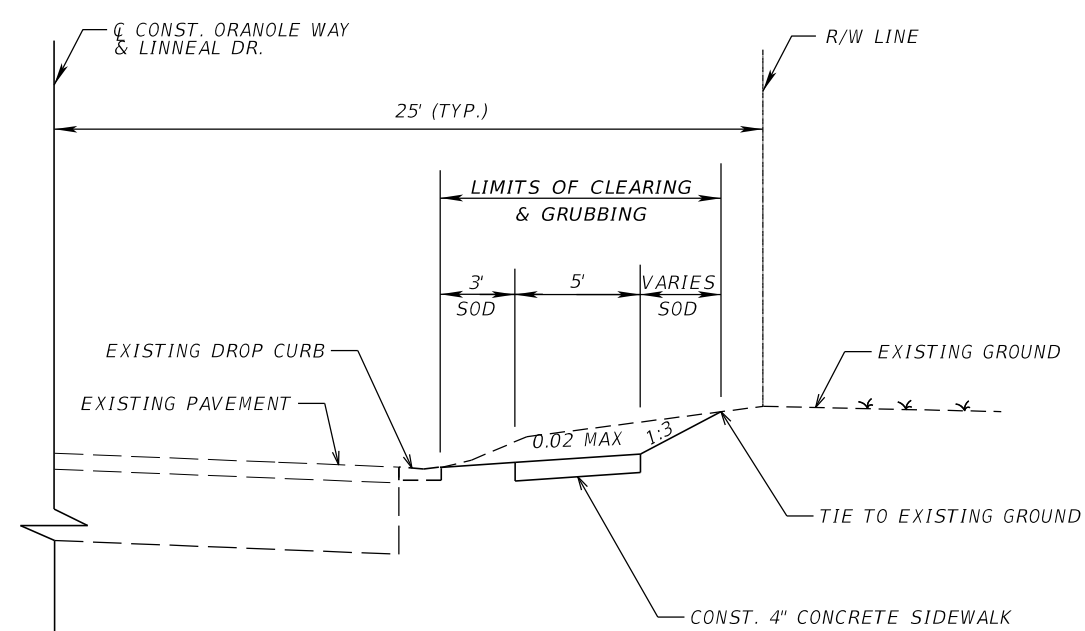

TYPICAL SECTION  
ORNOLE WAY  
STA. 10+25.95 TO STA. 16+95.63 (RT)

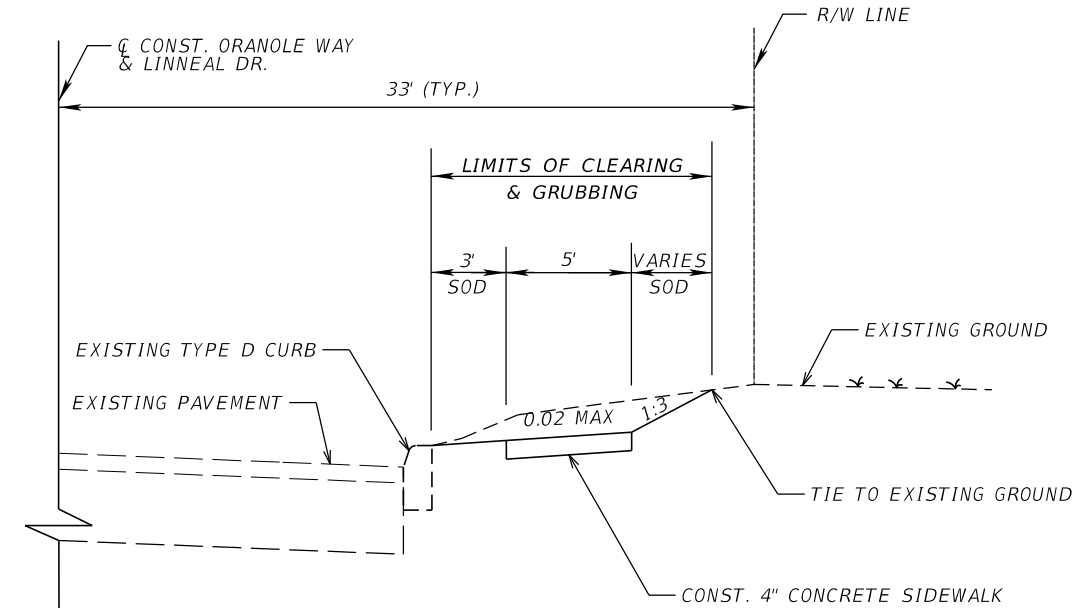

TYPICAL SECTION  
LINNEAL BEACH DRIVE  
STA. 16+95.63 TO STA. 19+96.42 (RT)

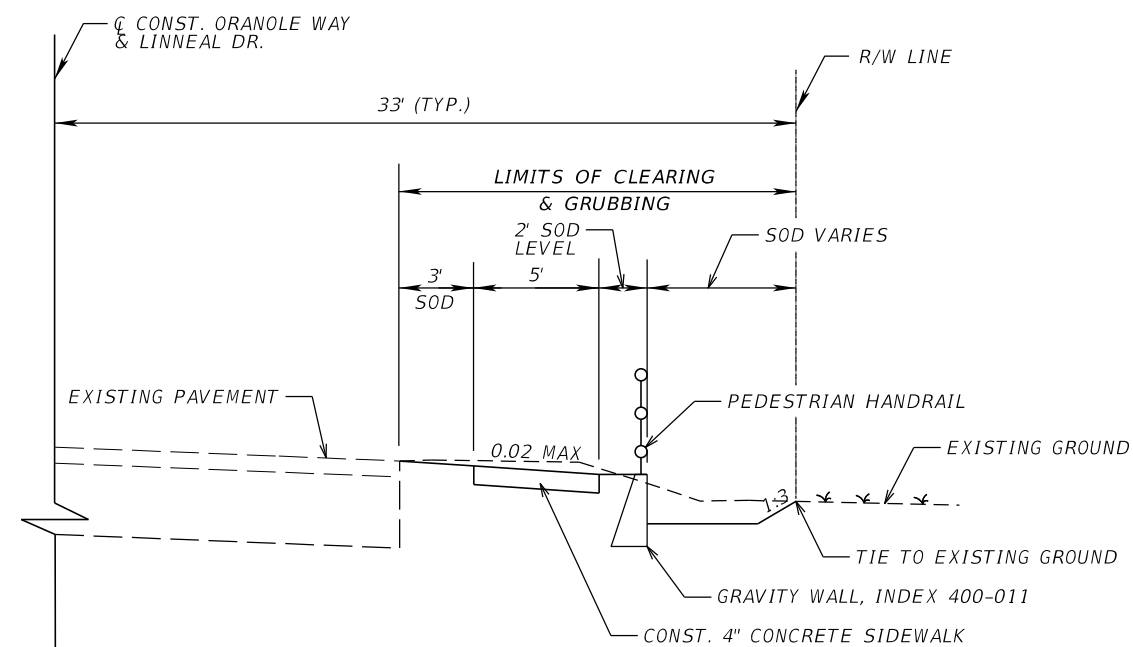

TYPICAL SECTION  
LINNEAL BEACH DRIVE  
STA. 19+96.42 TO STA. 26+86.76 (RT)

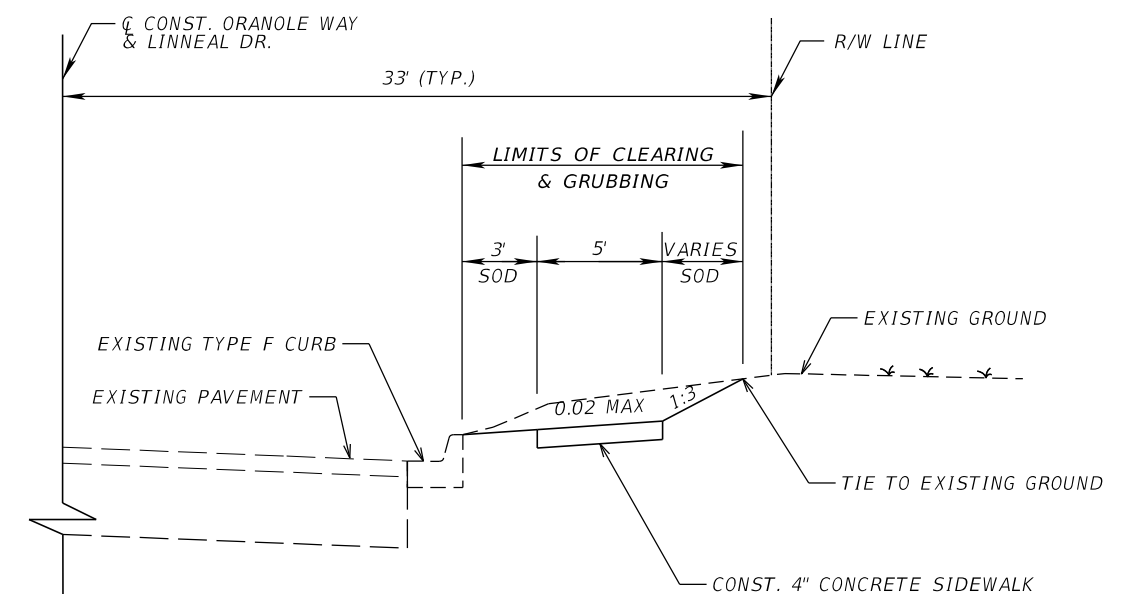

TYPICAL SECTION  
LINNEAL BEACH DRIVE  
STA. 26+86.76 TO STA. 27+59.40 (RT)

POSTED SPEED = 25 MPH

REVISIONS				 <b>SEMINOLE COUNTY</b> ENGINEERING DIVISION DINO LUCARELLI P.E. No. 39556 100 East 1st. Street Sanford, FL 32771	SEMINOLE COUNTY ENGINEERING DIVISION		TYPICAL SECTIONS	SHEET NO.
DATE	DESCRIPTION	DATE	DESCRIPTION		ROAD	COUNTY CIP No.		
					ORANOLE WAY & LINNEAL BEACH DR	02207081		3



REVISIONS				<div><div><div>SEMINOLE COUNTY</div><div>FLORIDA'S NATURAL CHOICE</div></div><div><div>SEMINOLE COUNTY</div><div>ENGINEERING DIVISION</div><div>DINO LUCARELLI</div><div>P.E. No. 39556</div><div>100 East 1st. Street</div><div>Sanford, FL 32771</div></div></div>	SEMINOLE COUNTY ENGINEERING DIVISION		PROJECT LAYOUT AND CONTROL	SHEET NO.
DATE	DESCRIPTION	DATE	DESCRIPTION		ROAD	COUNTY CIP No.		4
					ORANOLE WAY & LINNEAL BEACH DR	02207081		

PROJECT NOTES

1. BENCHMARK ELEVATIONS SHOWN ON THE PLANS ARE NORTH AMERICAN DATUM OF 1988 (NAVD 88) AND FIELD SURVEY BY SEMINOLE COUNTY SURVEYING DIVISION DATED 11/17/2022.
2. ANY PUBLIC LAND CORNER OR COUNTY MONUMENT WITHIN THE LIMITS OF CONSTRUCTION IS TO BE PROTECTED. IF A CORNER MONUMENT IS IN DANGER OF BEING DESTROYED AND HAS NOT BEEN PROPERLY REFERENCED, THE CONTRACTOR SHOULD NOTIFY THE SEMINOLE COUNTY SURVEYOR, SEMINOLE COUNTY PUBLIC WORKS DEPARTMENT IMMEDIATELY BY PHONE @ (407) 665-5647.
3. PROJECT STATIONS AND OFFSETS ARE BASED ON 0.00 ORANOLE WAY AND 0.00 LINNEAL BEACH DR.
4. ONE WEEK PRIOR TO CONSTRUCTION THE CONTRACTOR SHALL OBTAIN A "CONSTRUCTION PERMIT" FROM SEMINOLE COUNTY PUBLIC WORKS ENGINEERING DIVISION. CONTACT PERMIT COORDINATOR AT 100 E. FIRST STREET, SANFORD, FLORIDA 32773. TELEPHONE (407) 665-7336. NO FEES REQUIRED.
5. SPECIAL ATTENTION IS DIRECTED TO DESIGN STANDARD 304 & 310, AND STANDARD PLANS 522-001 AND 522-002.
6. ALL PERSONAL PROPERTY WITHIN THE RIGHT-OF-WAY SHALL BE RELOCATED BY THE PROPERTY OWNER OR IT SHALL BE REMOVED BY THE CONTRACTOR AS NECESSARY TO CONSTRUCT THE PROJECT IN ACCORDANCE WITH THE PLANS.
7. ALL PRIVATE AND PUBLIC PROPERTY AFFECTED BY THE CONSTRUCTION WORK SHALL BE RESTORED TO A CONDITION EQUAL TO OR BETTER, THAN THE EXISTING PRE-CONSTRUCTION CONDITION, UNLESS SPECIFICALLY EXEMPTED BY THE PLAN. COST TO BE INCIDENTAL TO CONSTRUCTION AND NO EXTRA COMPENSATION TO BE ALLOWED.
8. EXISTING UTILITY LOCATIONS SHOWN IN THE PLANS ARE ONLY APPROXIMATE. IT IS THE CONTRACTOR'S RESPONSIBILITY TO HAVE ALL EXISTING UNDERGROUND UTILITIES LOCATED IN THE FIELD AND NOTIFY ALL UTILITY OWNERS WHETHER PUBLIC OR PRIVATE, WITH FACILITIES IN THE AREA OF CONSTRUCTION ACTIVITIES FOR POSSIBLE CONFLICTS AND COORDINATE ANY ADJUSTMENT AND/OR RELOCATION AS NECESSARY TO COMPLETE THE PROJECT. ALL NOTIFICATIONS TO BE MADE ONE WEEK PRIOR TO THE COMMENCEMENT OF CONSTRUCTION. CONTACT SUNSHINE STATE ONE-CALL 1-800-432-4770.
9. IT IS THE RESPONSIBILITY OF THE CONTRACTOR TO COMPLY WITH THE CURRENT STATE UNDERGROUND FACILITY DAMAGE PREVENTION AND SAFETY ACT AND/OR RELATED STATE LAW. THE FOLLOWING INFORMATION IS BEING PROVIDED BY SEMINOLE COUNTY IN AN EFFORT TO ASSIST THE CONTRACTOR BY LISTING UTILITIES THAT MAY PROVIDE SERVICE IN THE APPROXIMATE AREA OF THE PROPOSED CONSTRUCTION. THE CONTRACTOR SHOULD ASSUME OTHER UTILITIES THAT ARE NOT LISTED BELOW MAY PROVIDE SERVICE IN THE APPROXIMATE AREA OF THE PROPOSED CONSTRUCTION.
- UTILITY (CONTACT)

PHONE

AT&T DISTRIBUTION (KIRBY SPENCER) (386) 366-4588

CHARTER COMMUNICATIONS (DAVID MCGREOR) (407) 532-8593

DUKE ENERGY DIST. (LATOYA JAMES) (407) 236-3241

DUKE ENERGY TRANSM. (SCOTT VANVELZOR) (727) 332-9403

SUNSHINE WATER SERVICES (BRYAN GONGRE) (321) 972-0360
10. GRADE SIDEWALK FOR POSITIVE DRAINAGE, CROSS SLOPE NOT TO EXCEED 1:50 (2%). NO SIDEWALK SHALL HAVE A LONGITUDINAL GRADE (SLOPE) GREATER THAN 1:20 (5%), CURB RAMPS SHALL NOT EXCEED 1:12 (8.33%).
11. THE CONTRACTOR MAY FIELD-ADJUST THE LOCATION OF THE SIDEWALK, AS NECESSARY, TO MAINTAIN 1-FOOT OFFSET DISTANCE TO ALL FIXED OBSTACLES AND VERTICAL DROP-OFFS. ANY ADJUSTMENT MUST BE APPROVED BY SEMINOLE COUNTY ENGINEERING INSPECTOR PRIOR TO PLACEMENT OF ANY CONCRETE.
12. IT IS THE RESPONSIBILITY OF THE CONTRACTOR TO CHECK ALL CONCRETE FORMS PRIOR TO CONCRETE BEING POURED AND CONFIRM THAT THE FINISHED SIDEWALK AND/OR CURB RAMP MEET ADA REQUIREMENTS AS INTENDED. FAILURE TO DO SO MAY RESULT IN THE REMOVAL AND REPLACEMENT OF THE CONCRETE AT THE CONTRACTOR'S EXPENSE.
13. A MINIMUM OF 2 FEET ON BOTH SIDES OF THE SIDEWALK SHALL BE RE-SODDED AND ALL DISTURBED AREAS WILL BE RE-SODDED TO MATCH THE EXISTING SOD TYPE, UNLESS OTHERWISE NOTED IN THE PLANS. SOD SHALL BE CERTIFIED "SODA APPLE FREE". SUBCONTRACTOR SHALL REMOVE AND REPLACE ANY AREAS AFFECTED FOR A PERIOD OF ONE YEAR FROM THE COMPLETION OF THE PROJECT.
14. SOIL MATERIALS USED FOR FILL OR GRADING ACTIVITIES SHALL BE APPROVED FOR USE BY THE SEMINOLE COUNTY ENGINEERING INSPECTOR PRIOR TO USE.
15. ANY GRASSED AREA OUTSIDE THE IMMEDIATE CONSTRUCTION AREA DISTURBED BY THE CONTRACTOR WILL BE SODDED AT THE CONTRACTOR'S EXPENSE. WITHIN 48 HOURS OF NOTIFICATION BY THE SEMINOLE COUNTY PROJECT MANAGER.
16. IRRIGATION LINES DAMAGED DURING CONSTRUCTION ARE TO BE CAPPED IMMEDIATELY AND REPORTED TO THE SEMINOLE COUNTY ENGINEER INSPECTOR. IT IS THE RESPONSIBILITY OF THE CONTRACTOR TO REPAIR AND/OR REPLACE THE DAMAGED IRRIGATION COMPONENTS TO PRE-CONSTRUCTION CONDITION PRIOR TO COMPLETION OF THE PROJECT. COST TO INCLUDED IN 110-1-1.
17. THE CONTRACTOR SHALL NOTIFY THE SEMINOLE COUNTY PROJECT MANAGER FOR A FIELD INSPECTION 24 HOURS PRIOR TO PLACEMENT OF ANY CONCRETE.
18. THE TEST REQUIREMENTS FOR CLASS I CONCRETE WILL BE WAIVED UPON PRESENTATION TO THE SEMINOLE COUNTY ENGINEERING INSPECTOR WITH A WRITTEN CERTIFICATION FROM THE PLANT THAT THE CONCRETE IS A FDOT CLAS I MIX FOR 3000 PSI CONCRETE.

19. THE CONTRACTOR SHALL REMOVE AND DISPOSE PROPERLY OF ALL CONSTRUCTION DEBRIS PRIOR TO COMPLETION OF THE PROJECT.
20. SHRUBS AND TREES THAT CONFLICT WITH THE PROPOSED SIDEWALK SHALL BE REMOVED. NO TREES ARE TO BE REMOVED WITHOUT THE APPROVAL FROM THE SEMINOLE COUNTY PROJECT MANAGER.
21. EXISTING DRAINAGE STRUCTURES TO REMAIN UNLESS OTHERWISE NOTED.
22. ANY DRAINAGE PROBLEMS, CREATED BY CONSTRUCTION OR EXISTING BEFORE CONSTRUCTION, THAT ARE NOT ALLEVIATED SHOULD BE BROUGHT TO THE ATTENTION OF THE SEMINOLE COUNTY ENGINEERING DIVISION PROJECT MANAGER.

EROSION CONTROL NOTES

1. THE EROSION CONTROL MEASURES PER FDOT EROSION AND SEDIMENT CONTROL MANUAL ARE THE MINIMUN REQUIRED. ADDITIONAL EROSION CONTROL MEASURES MAY BE REQUIRED DUE TO FIELD CONDITIONS AS DETERMINED BY THE SEMINOLE COUNTY PROJECT MANAGER OR THE REGULATORY AGENCIES.
2. PROVIDE EROSION AND SEDIMENTATION CONTROL MEASURES CONSISTING OF STAKED SILT FENCES AND ADDITIONAL MEASURES AS NECESSARY, UTILIZING INDUSTRY STANDARD BEST MANAGMENT PRACTICES AND FOLLOWING REQUIREMENTS BELOW, TO AVOID ADVERSE IMPACTS TO JURISDICTIONAL AREAS (WETLANDS, WATER BODIES, AND UPLAND BUFFERS) AND OFF SITE LANDS AND WATER BODIES. MAINTAIN THESE MEASURES DAILY UNTIL CONSTRUCTION ACCEPTANCE BY SEMINOLE COUNTY AND THEN REMOVE AND LEGALLY DISPOSE OF SAID MEASURES.
3. NO DISCHARGE OF CONTAMINANTS INTO ADJACENT WETLANDS, WATER BODIES, OR UPLAND BUFFERS WILL BE PERMITTED AT ANY TIME.
4. DAMAGE TO WETLANDS AND/OR UPLAND BUFFERS ADJACENT TO CONSTRUCTION AREAS SHALL BE PREVENTED BY DELINEATING THE LIMITS OF CONSTRUCTION, AND INSTALLING SEDIMENT BARRIERS PRIOR TO THE COMMENCEMENT OF CONSTRUCTION ACTIVITIES, THEREBY RETAINING SEDIMENT WITHIN THE CONSTRUCTION AREA. CONTRACTOR WILL BE REQUIRED TO ADEQUATELY MAINTAIN THESE PROTECTION MEASURES AT ALL TIMES.
5. EROSION CONTROL AND DUST CONTROL SHALL BE MAINTAINED WITHIN CONSTRUCTION AREAS BY QUICKLY STABILIZING DISTURBED AREAS TO PREVENT THE RELEASE OF SEDIMENT. THIS SHALL BE ACCOMPLISHED USING GRASS COVER, TURBIDITY FENCES, PERIODIC WATERING, AND OTHER BEST MANAGMENT PRACTICES WHICH ARE ACCEPTABLE TO THE SEMINOLE COUNTY ENGINEERING INSPECTOR AND REGULATORY AGENCIES.
6. TURBIDITY BARRIERS SHALL BE USED TO PREVENT RELEASE OF SEDIMENT AND/OR TURBID WATER INTO SURROUNDING WATERS. THESE SEDIMENT AND TURBIDITY BARRIERS SHALL BE MAINTAINED THROUGHOUT THE CONSTRUCTION PERIOD.
7. ALL EROSION PREVENTION AND CONTROL MEASURES MUST BE INSPECTED AND APPROVED BY THE COUNTY COMPLIANCE PERSONNEL, AS REQUIRED, PRIOR TO ANY CONSTRUCTION ACTIVITIES. REMOVAL OF THESE SAME EROSION CONTROLS AND PREVENTION MEASURES MAY BE DONE ONLY AFTER AUTHORIZATION BY COUNTY PERSONNEL IS OBTAINED.
8. ALL SURFACE WATER DISCHARGE FROM SITE, INCLUDING DEWATERING DISCHARGE, SHALL MEET CURRENT STATE WATER QUALITY STANDARDS PRIOR TO REACHING ANY WATERS OF THE STATE INCLUDING WETLANDS.
9. ALL STORM DRAINAGE INLETS AND PIPES SHALL BE PROTECTED FROM SILT, SAND AND DEBRIS DURING CONSTRUCTION. ANY ACCUMULATION WITHIN THE STORM DRAINAGE PIPE SYSTEM SHALL BE REMOVED WITHOUT PUMPING OR FLUSHING. STORM DRAINAGE SYSTEM SHALL BE CLEANED AND FREE OF DEBRIS PRIOR TO ENGINEER'S INPECTOR'S ACCEPTANCE.

TEMPORARY TRAFFIC CONTROL NOTES

1. VEHICULAR AND PEDESTRIAN TRAFFIC SHALL BE MAINTAINED IN ACCORDANCE WITH FDOT STANDARD PLANS, INDEX 600 SERIES, AND THE STANDARD SPECIFICATIONS FOR ROAD AND BRIDGE CONSTRUCTION AND THE LATEST MANUAL ON UNIFORM TRAFFIC CONTROL DEVICES (MUTCD) AS A MINIMUM.
2. SEMINOLE COUNTY IS ADMINISTERING THE CONSTRUCTION OF THIS PROJECT. IT IS THE COUNTY'S POLICIES TO PLACE THE RESPONSIBILITY FOR MAINTENANCE OF TRAFFIC DURING CONSTRUCTION ON THE CONTRACTOR. THE CONTRACTOR WILL BE REQUIRED TO SUBMIT A TRAFFIC CONTROL PLAN SIGNED AND SEALED BY A STATE OF FLORIDA REGISTERED PROFESSIONAL ENGINEER TO THE COUNTY PRIOR TO BEGINNING THE PROECT. THE APPLICATION AND REFERENCE OF SPECIFIC FDOT DESIGN STANDARD INDICES IS ACCEPTABLE.
3. WORK HOURS ARE FROM 8:00 A.M. TO 5:00 P.M. MONDAY TO FRIDAY. WORK WILL NOT BE ALLOWED ON WEEKENDS OR HOLIDAYS OBSERVED BY SEMINOLE COUNTY.
4. LANE CLOSURES SHALL BE PERMITTED ONLY DURING ACTIVE WORK PERIODS AND AS FOLLOWS:  
ORANOLE WAY: MONDAY TO FRIDAY FROM 8:30AM TO 4:30PM  
LINNEAL BEACH DR: MONDAY TO FRIDAY FROM 8:30AM TO 4:30PM
5. USE CHANGEABLE MESSAGE SIGNS AT BEGIN AND END PROJECT 500' BEFORE SIGNAGE (7) DAYS PRIOR TO CONSTRUCTION AND FOR THE PROJECT DURATION COORDINATE LOCATION, WITH SEMINOLE COUNTY PROJECT MANAGER.

REVISIONS				<div><div><div><div><div><div></div><div><div>SEMINOLE COUNTY</div><div>FLORIDA'S NATURAL CHOICE</div></div></div><div><div>SEMINOLE COUNTY</div><div>ENGINEERING DIVISION</div></div><div><div>DINO LUCARELLI</div><div>P.E. No. 39556</div><div>100 East 1st. Street</div><div>Sanford, FL 32771</div></div></div></div></div></div>	SEMINOLE COUNTY ENGINEERING DIVISION		GENERAL NOTES	SHEET NO.
DATE	DESCRIPTION	DATE	DESCRIPTION					
					5			





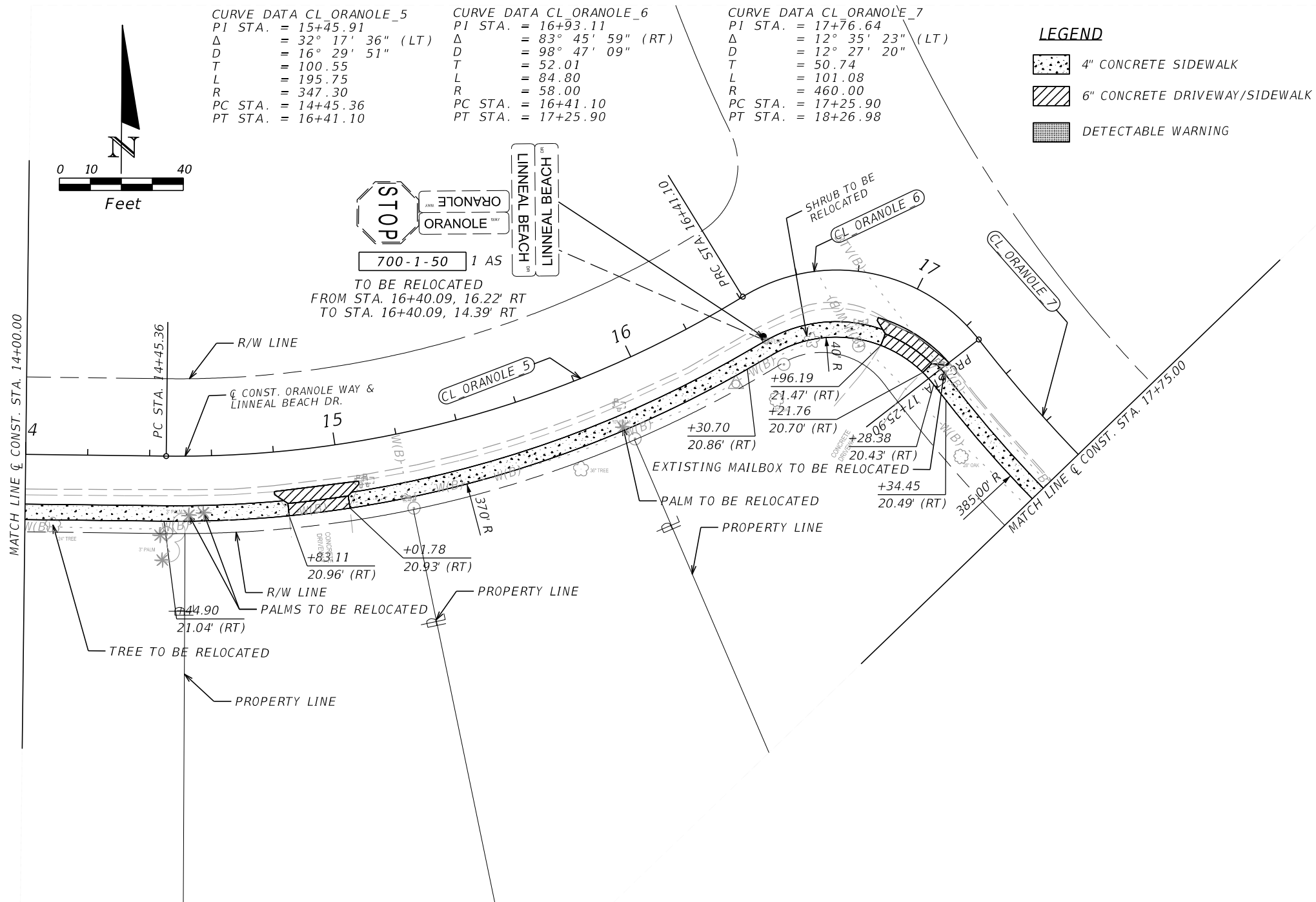

REVISIONS				<div>SEMINOLE COUNTY ENGINEERING DIVISION</div> <div>DINO LUCARELLI P.E. No. 39556 100 East 1st. Street Sanford, FL 32771</div>	SEMINOLE COUNTY ENGINEERING DIVISION		PLAN SHEET	SHEET NO.  7
DATE	DESCRIPTION	DATE	DESCRIPTION		ROAD	COUNTY CIP No.		
					ORANOLE WAY & LINNEAL BEACH DR	02207081		

CURVE DATA CL\_ORANOLE\_7  
PI STA. = 17+76.64  
Δ = 12° 35' 23" (LT)  
D = 12° 27' 20"  
T = 50.74  
L = 101.08  
R = 460.00  
PC STA. = 17+25.90  
PT STA. = 18+26.98

CURVE DATA CL\_ORANOLE\_10  
PI STA. = 19+72.80  
Δ = 51° 07' 13" (RT)  
D = 98° 47' 09"  
T = 27.74  
L = 51.75  
R = 58.00  
PC STA. = 19+45.06  
PT STA. = 19+96.81

CURVE DATA CL\_ORANOLE\_11  
PI STA. = 23+28.23  
Δ = 70° 16' 10" (LT)  
D = 12° 09' 58"  
T = 331.42  
L = 577.59  
R = 470.95  
PC STA. = 19+96.81  
PT STA. = 25+74.40

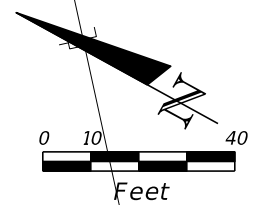
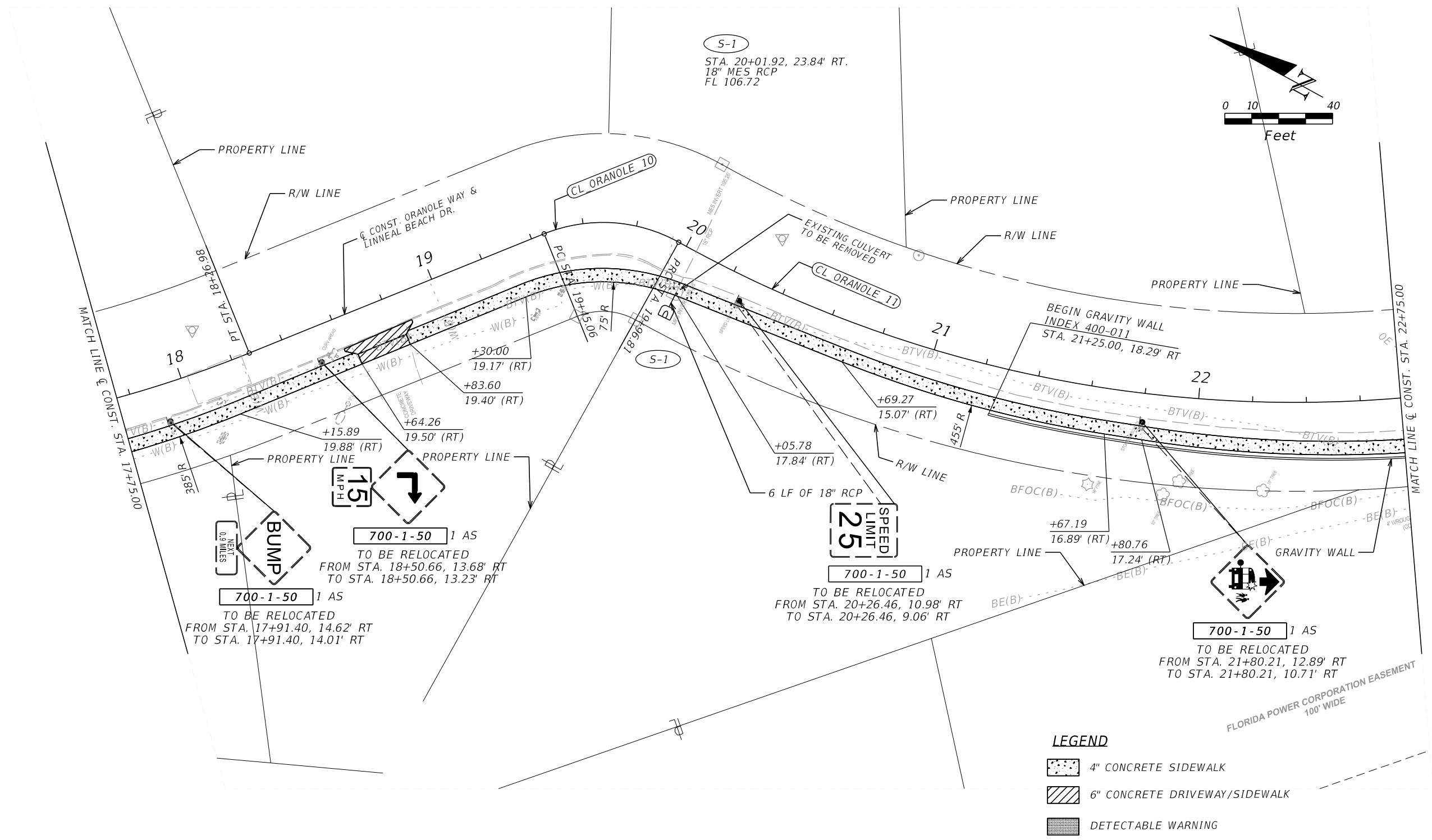





LEGEND

- 4" CONCRETE SIDEWALK
- 6" CONCRETE DRIVEWAY/SIDEWALK
- DETECTABLE WARNING

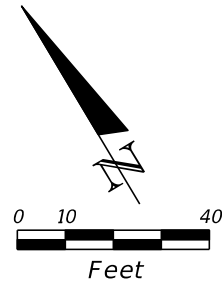
REVISIONS				<div>SEMINOLE COUNTY ENGINEERING DIVISION</div> <div>DINO LUCARELLI P.E. No. 39556 100 East 1st. Street Sanford, FL 32771</div>	SEMINOLE COUNTY ENGINEERING DIVISION		PLAN SHEET	SHEET NO. 8
DATE	DESCRIPTION	DATE	DESCRIPTION		ROAD	COUNTY CIP No.		
					ORANOLE WAY & LINNEAL BEACH DR	02207081		





 4" CONCRETE SIDEWALK  
 6" CONCRETE DRIVEWAY/SIDEWALK  
 DETECTABLE WARNING

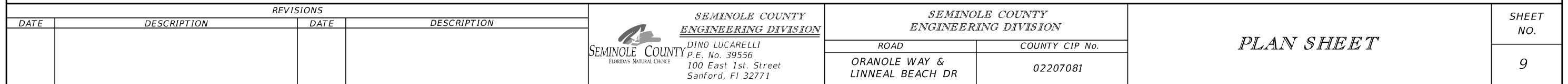

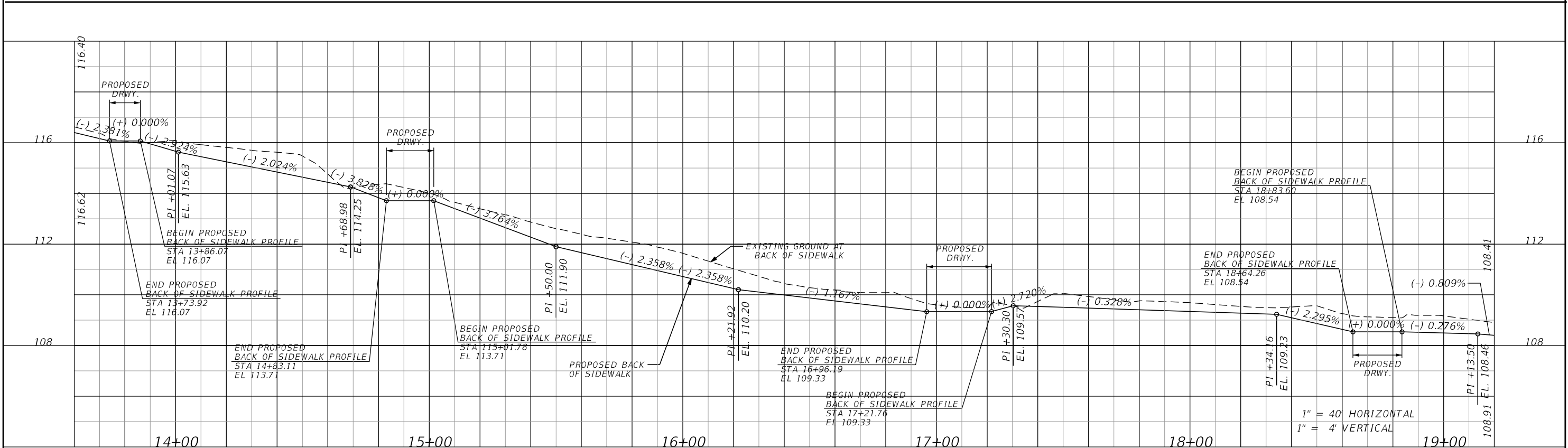
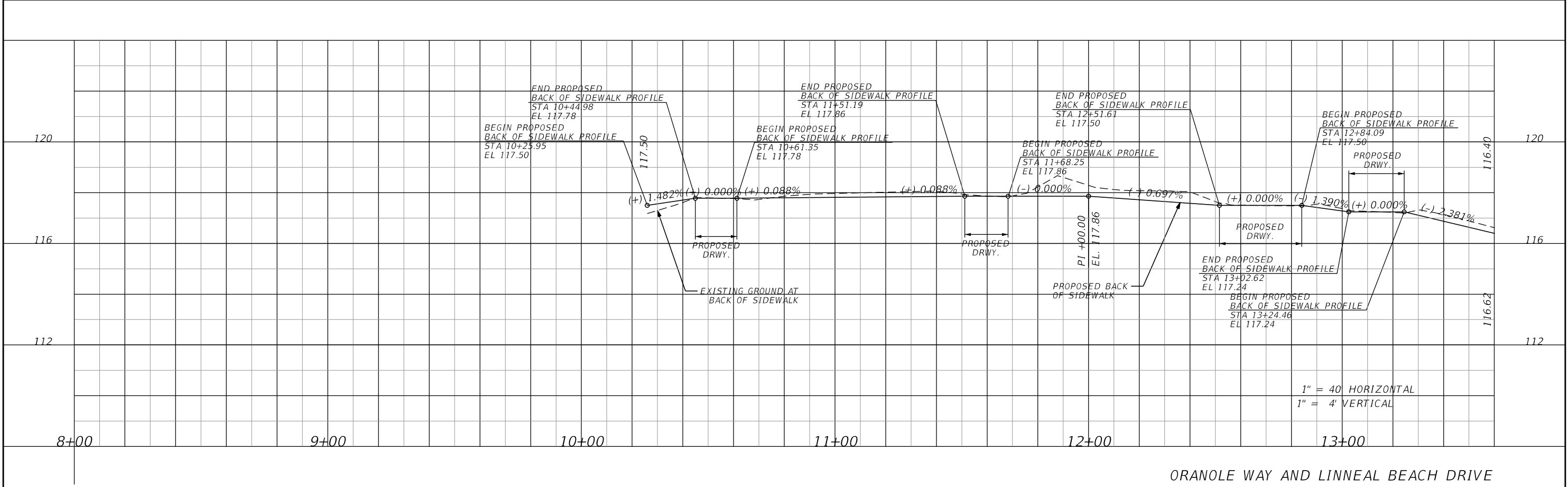

REVISIONS				<div><div></div><div><b>SEMINOLE COUNTY</b> FLORIDA'S NATURAL CHOICE</div></div>	<div><b>SEMINOLE COUNTY</b> <b>ENGINEERING DIVISION</b> DINO LUCARELLI P.E. No. 39556 100 East 1st. Street Sanford, FL 32771</div>	<b>SEMINOLE COUNTY</b> <b>ENGINEERING DIVISION</b>		<div><b>PROFILE SHEET</b> <b>BACK OF SIDEWALK</b></div>	SHEET NO.  10
DATE	DESCRIPTION	DATE	DESCRIPTION			ROAD	COUNTY CIP No.		
						ORANOLE WAY & LINNEAL BEACH DR	02207081		

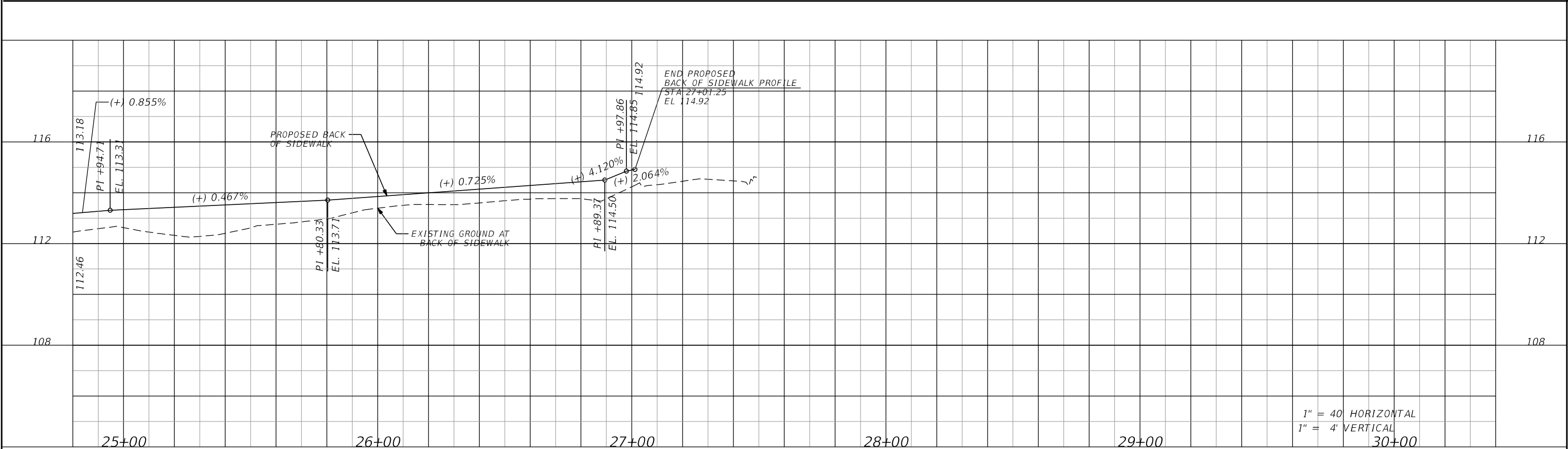
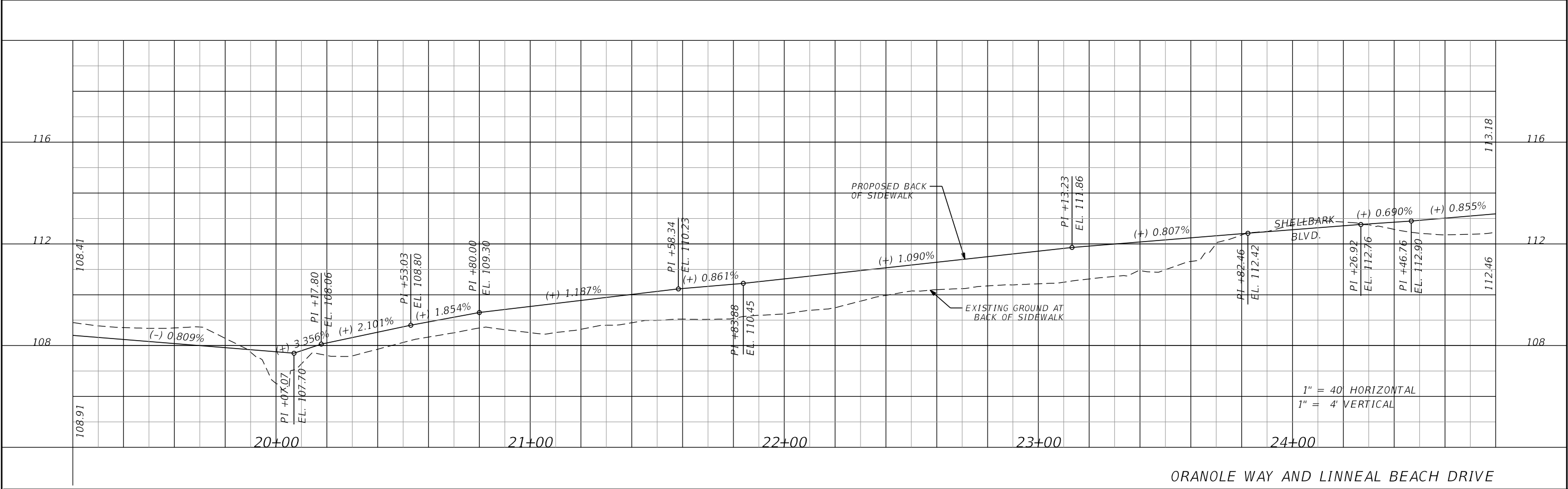

REVISIONS				<div> <b>SEMINOLE COUNTY</b> <small>FLORIDA'S NATURAL CHOICE</small></div> <div><b>SEMINOLE COUNTY ENGINEERING DIVISION</b> DINO LUCARELLI P.E. No. 39556 100 East 1st. Street Sanford, FL 32771</div>	<b>SEMINOLE COUNTY ENGINEERING DIVISION</b>		<b>PROFILE SHEET BACK OF SIDEWALK</b>	SHEET NO.
DATE	DESCRIPTION	DATE	DESCRIPTION					
				ROAD		COUNTY CIP No.		
				ORANOLE WAY & LINNEAL BEACH DR		02207081	11	

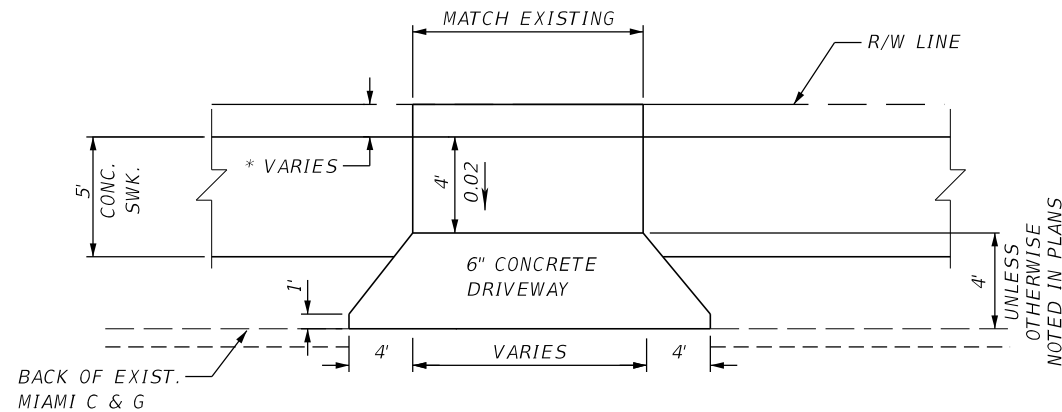

### TYPICAL CONCRETE DRIVEWAY DETAIL

THE CONTRACTOR SHALL SAW CUT AND REMOVE ANY ASPHALT APRON THAT IS WITHIN THE LIMITS OF THE NEW CONCRETE DRIVEWAY. THE CONTRACTOR SHALL SOD ANY AREA NOT COVERED BY CONCRETE.

REFER TO DRIVEWAY X-SECTIONS FOR DIMENSIONS AND PROPOSED GRADES.

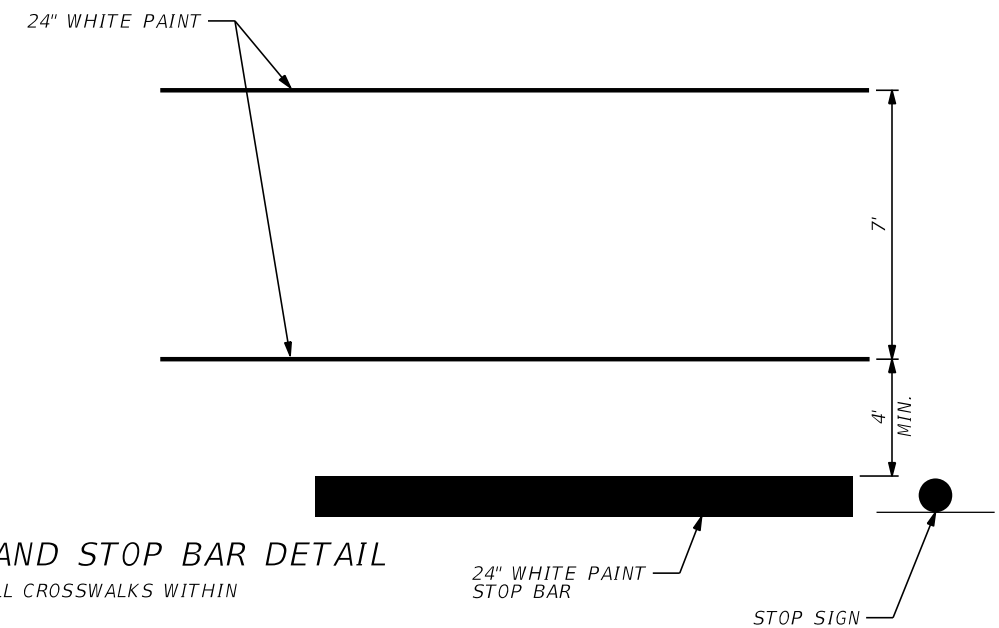

### CROSSWALK AND STOP BAR DETAIL

NOTE: TYPICAL FOR ALL CROSSWALKS WITHIN PROJECT LIMITS.  
REPAINT OR CONSTRUCT NEW STOP BARS AND STOP SIGNS (IF REQUIRED) AT ALL INTERSECTIONS WITHIN THIS PROJECT.

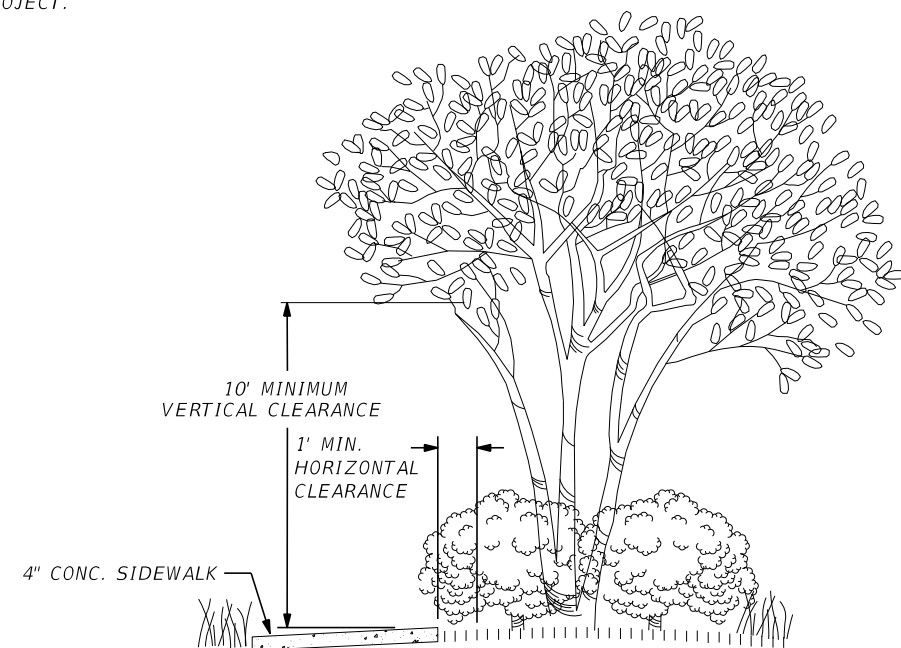

### TREE SIDEWALK DETAIL

NOTE: THE CONTRACTOR SHALL TRIM ALL BUSHES AND TREES TO MAINTAIN AT LEAST A MINIMUM 10 FEET VERTICAL CLEARANCE AND ONE FOOT HORIZONTAL CLEARANCE.

REVISIONS				<div><div>SEMINOLE COUNTY FLORIDA'S NATURAL CHOICE</div></div> <div><div>SEMINOLE COUNTY ENGINEERING DIVISION</div><div>DINO LUCARELLI P.E. No. 39556 100 East 1st. Street Sanford, FL 32771</div></div>	SEMINOLE COUNTY ENGINEERING DIVISION		SPECIAL DETAILS	SHEET NO.
DATE	DESCRIPTION	DATE	DESCRIPTION		ROAD	COUNTY CIP No.		12
					ORANOLE WAY & LINNEAL BEACH DR	02207081		

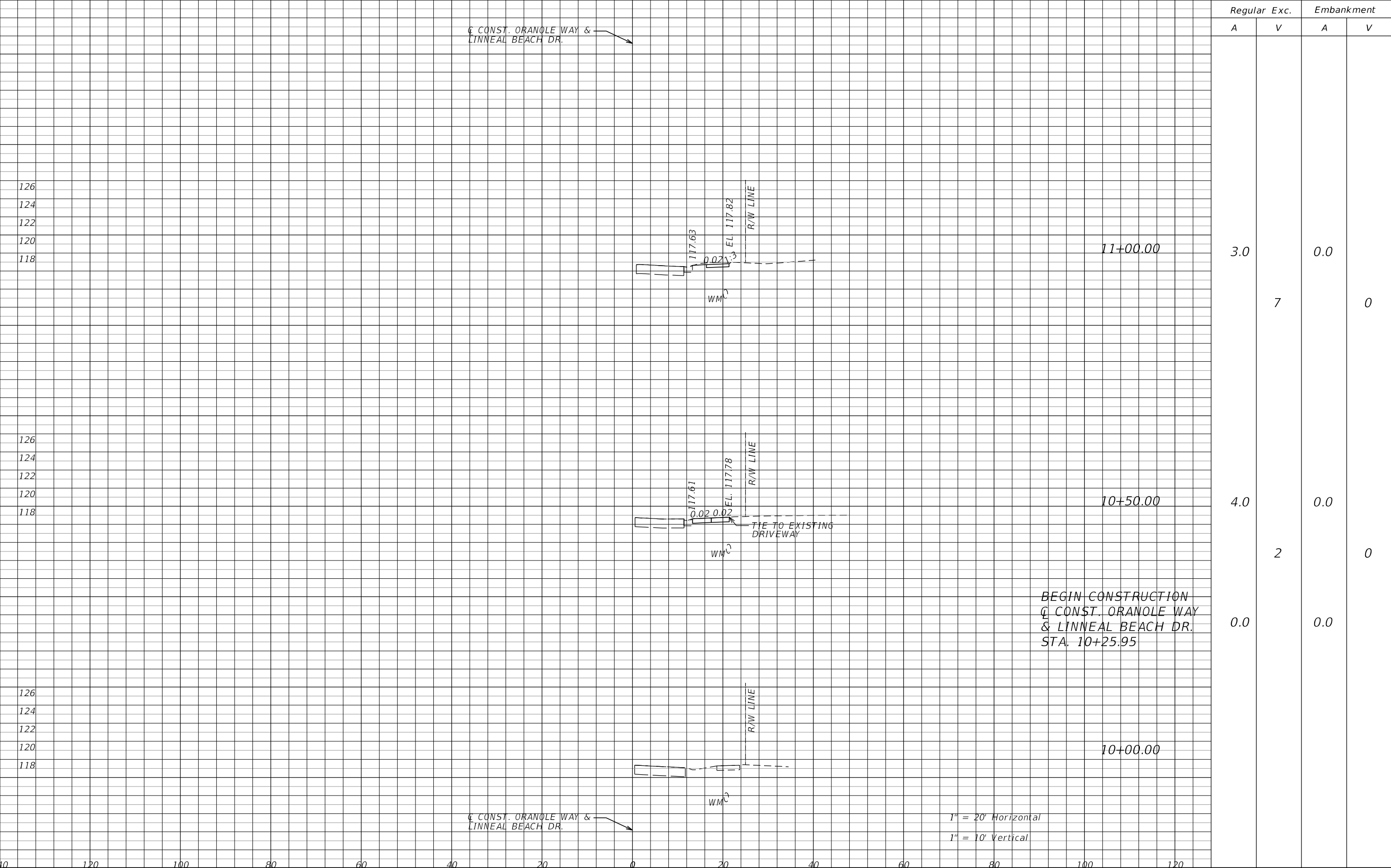

Regular		Exc.		Embankment	
A	V	A	V	A	V

3.0		0.0			
	7				0
4.0		0.0			
	2				0
0.0		0.0			

BEGIN CONSTRUCTION  
CONST. ORANOLE WAY & LINNEAL BEACH DR.  
STA. 10+25.95

1" = 20' Horizontal  
1" = 10' Vertical



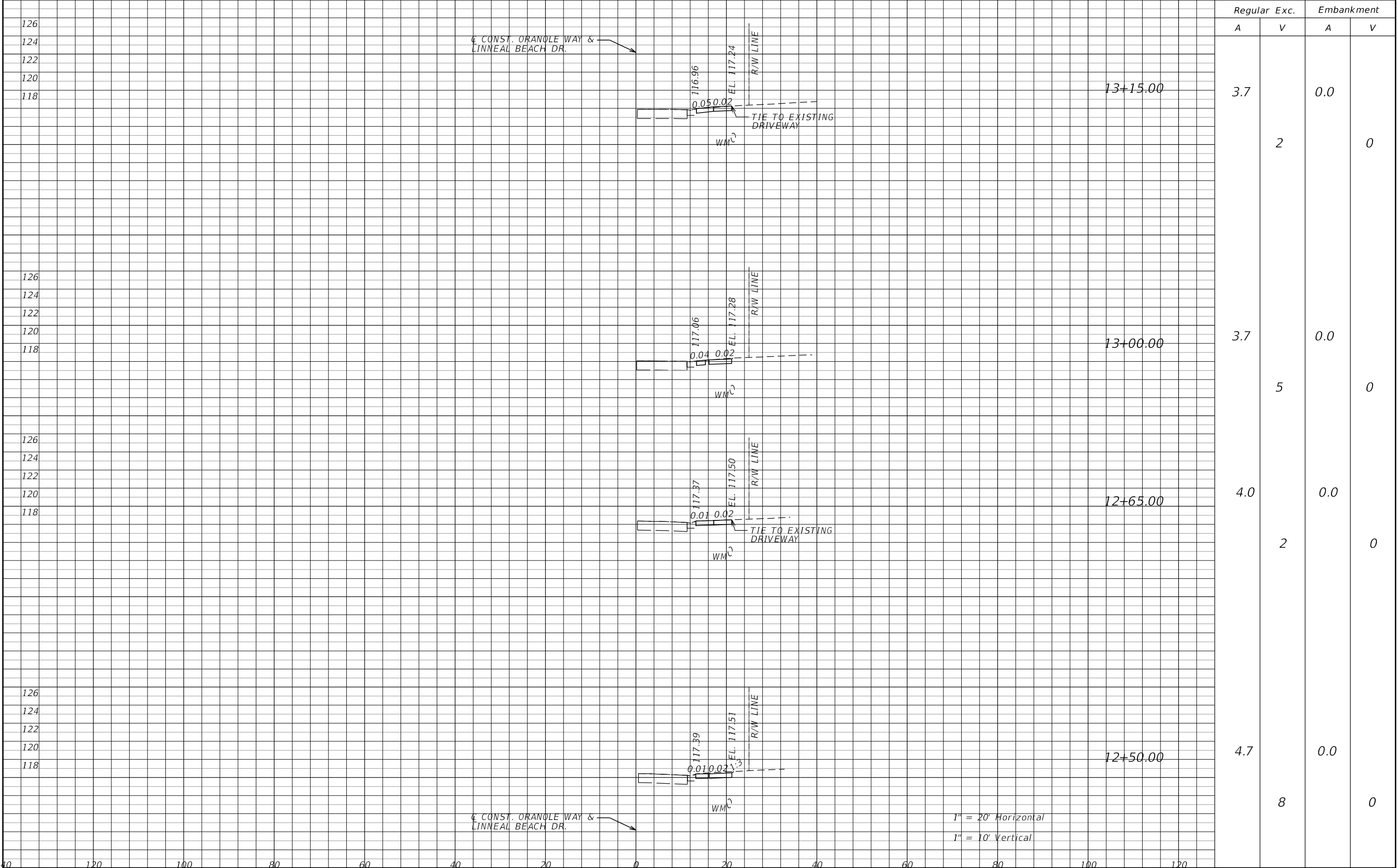

Regular		Exc.	Embankment	
A	V	A	V	
3.7	2	0.0	0	
3.7	5	0.0	0	
4.0	2	0.0	0	
4.7	8	0.0	0	





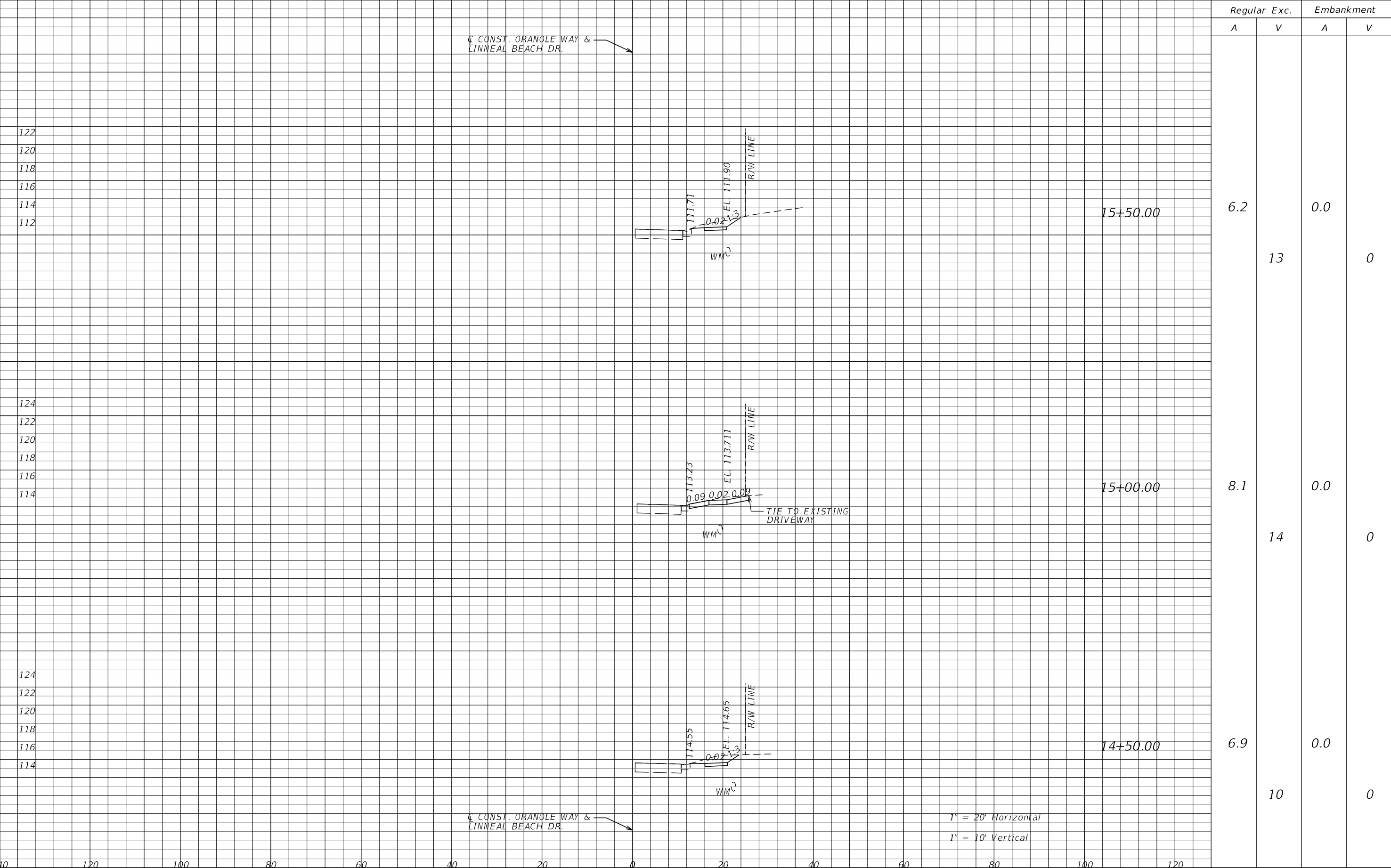

Regular		Exc.		Embankment	
A	V	A	V	A	V

6.2

13

0.0

0

8.1

14

0.0

0

6.9

10

0.0

0

15+50.00

15+00.00

14+50.00

TIE TO EXISTING DRIVEWAY

1" = 20' Horizontal

1" = 10' Vertical

REVISIONS				<div><div>SEMINOLE COUNTY ENGINEERING DIVISION</div><div>DINO LUCARELLI P.E. No. 39556 100 East 1st. Street Sanford, FL 32771</div></div>	SEMINOLE COUNTY ENGINEERING DIVISION		<div>CROSS-SECTIONS</div>	SHEET NO.
DATE	DESCRIPTION		DESCRIPTION		ROAD	COUNTY CIP No.		17
					ORANOLE WAY & LINNEAL BEACH DR	02207081		

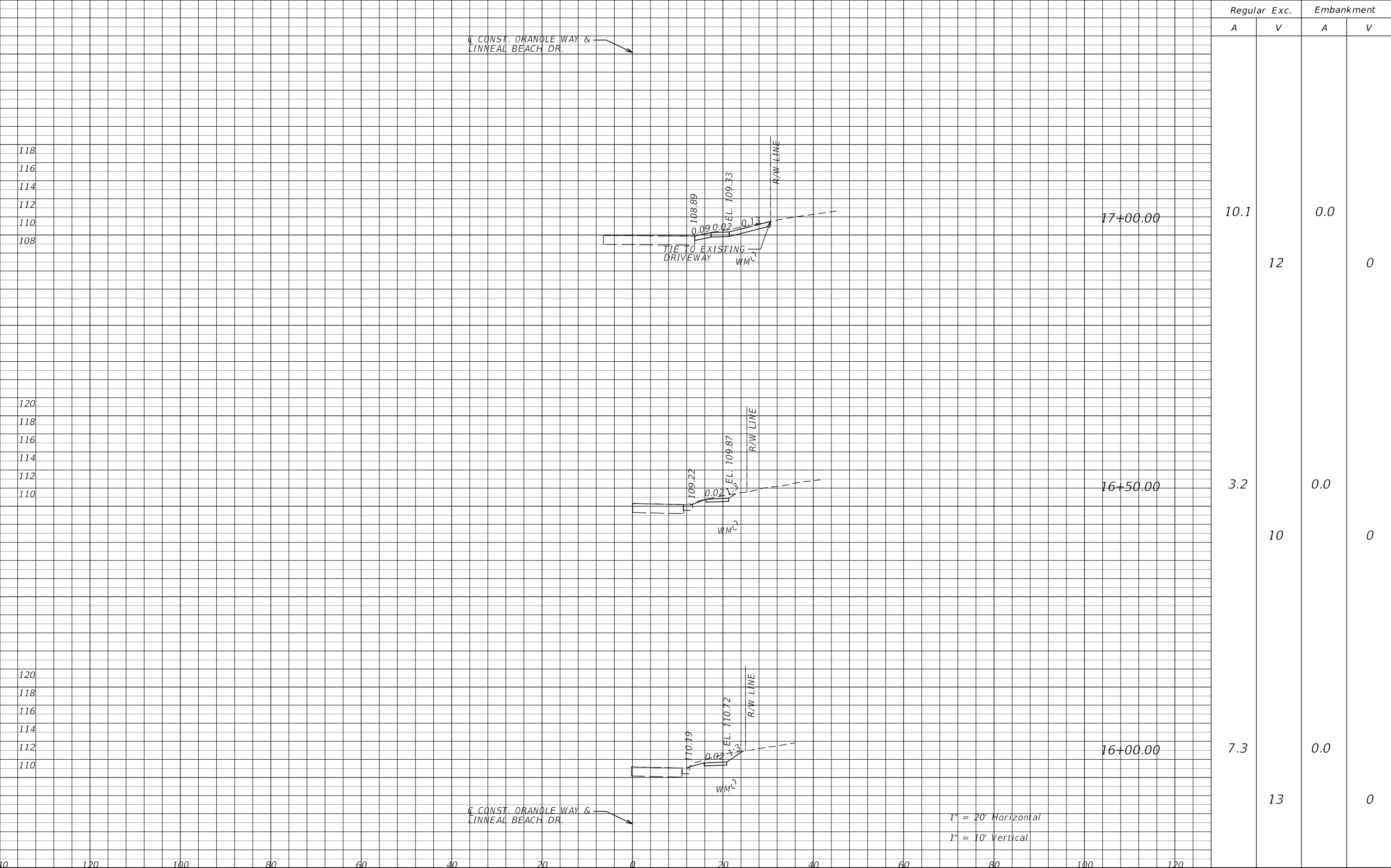

REVISIONS				<div><div><b>SEMINOLE COUNTY</b> <b>ENGINEERING DIVISION</b> DINO LUCARELLI P.E. No. 39556 100 East 1st. Street Sanford, FL 32771</div></div>	SEMINOLE COUNTY ENGINEERING DIVISION		<i>CROSS-SECTIONS</i>	SHEET NO.
DATE	DESCRIPTION		DESCRIPTION		ROAD	COUNTY CIP No.		18
					ORANOLE WAY & LINNEAL BEACH DR	02207081		

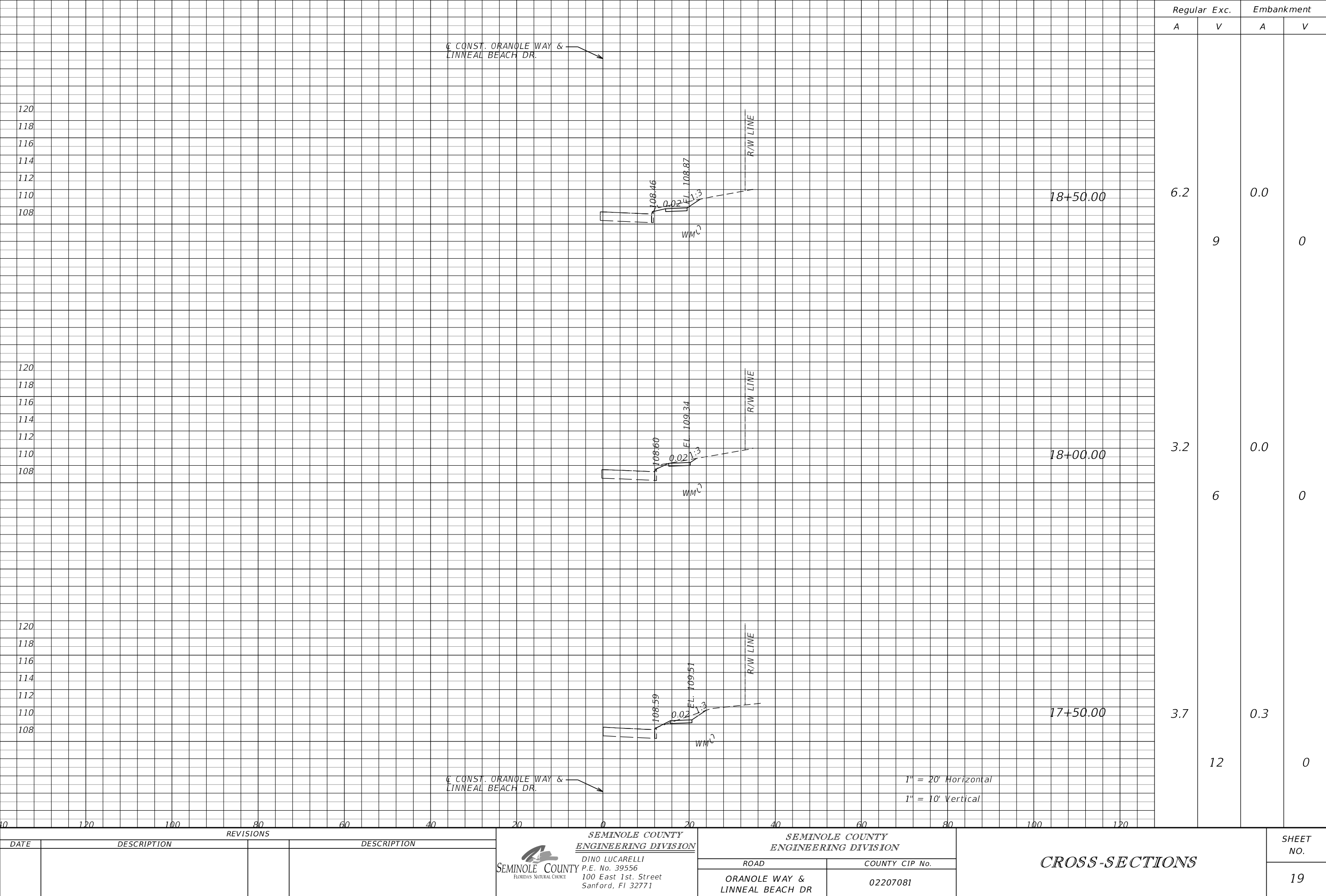

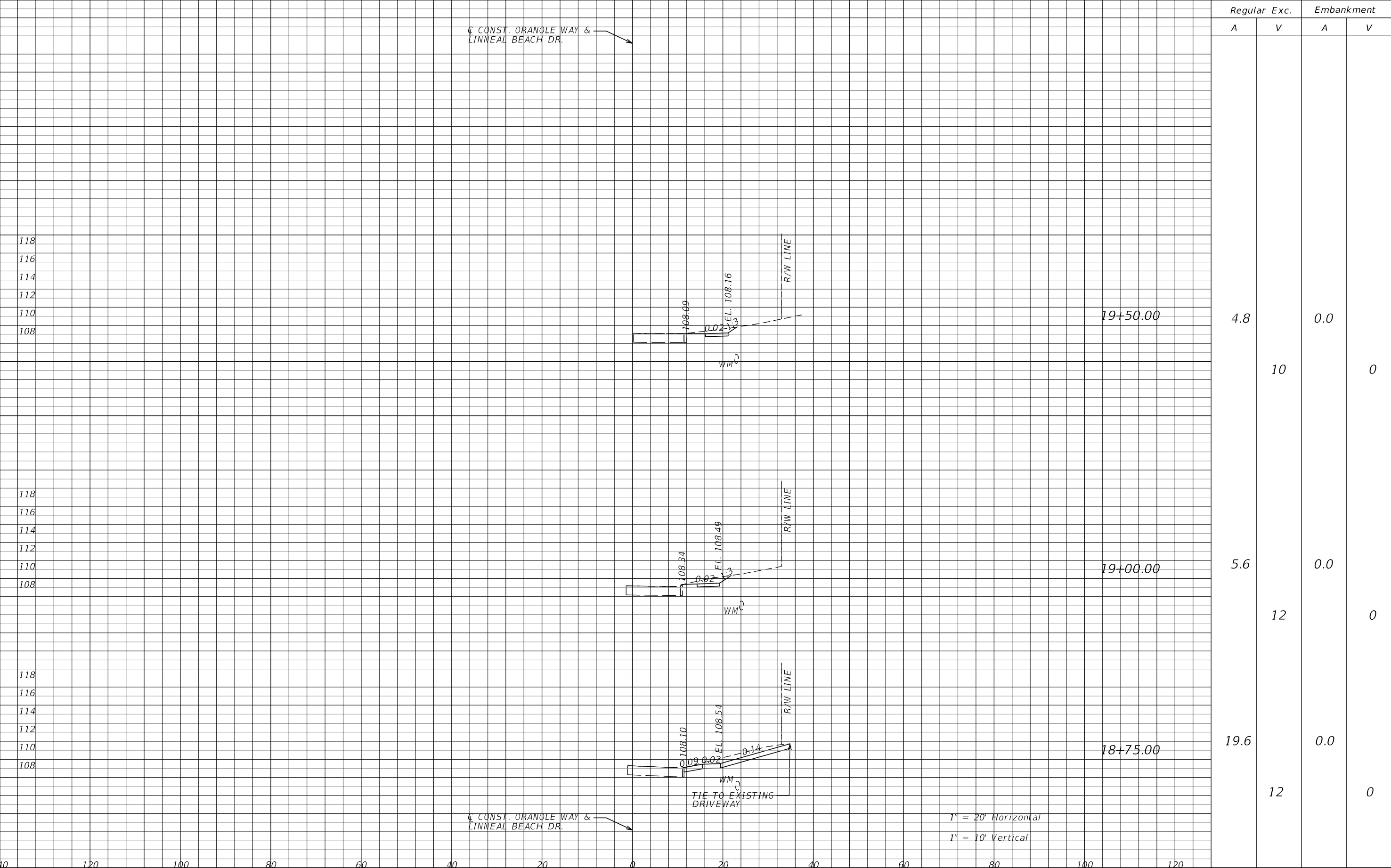

Regular		Exc.	Embankment	
A	V	A	A	V
4.8	10	0.0	0	
5.6	12	0.0	0	
19.6	12	0.0	0	



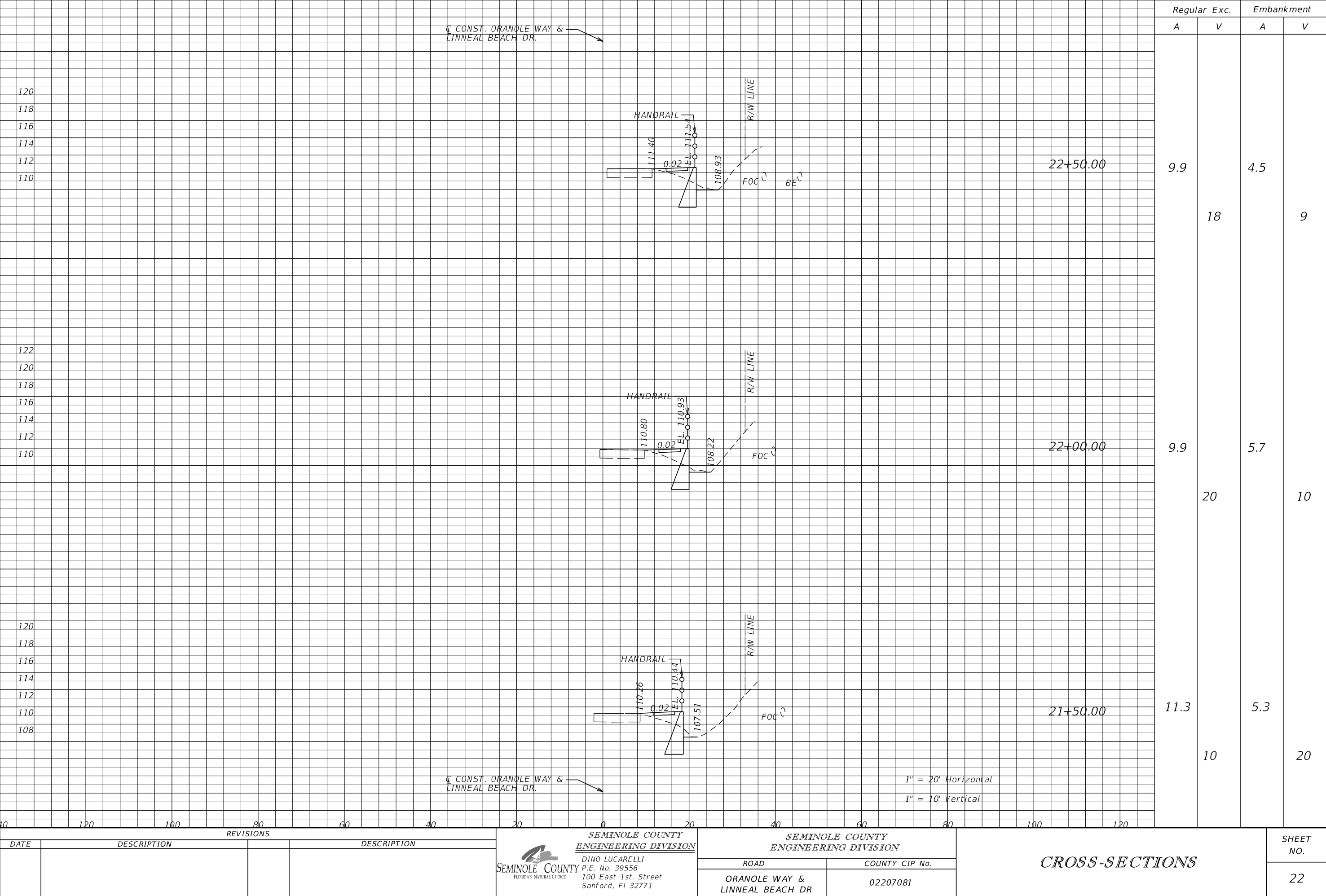

Regular Exc. Embankment

A V A V

9.9 4.5

18 9

9.9 5.7

20 10

11.3 5.3

10 20

REVISIONS			
DATE	DESCRIPTION	DESCRIPTION	



**SEMINOLE COUNTY**  
FLORIDA'S NATURAL CHOICE

**SEMINOLE COUNTY  
ENGINEERING DIVISION**

DINO LUCARELLI  
P.E. No. 39556  
100 East 1st. Street  
Sanford, FL 32771

SEMINOLE COUNTY ENGINEERING DIVISION	
ROAD	COUNTY CIP No.
ORANOLE WAY & LINNEAL BEACH DR	02207081

CROSS-SECTIONS	

SHEET NO.
22



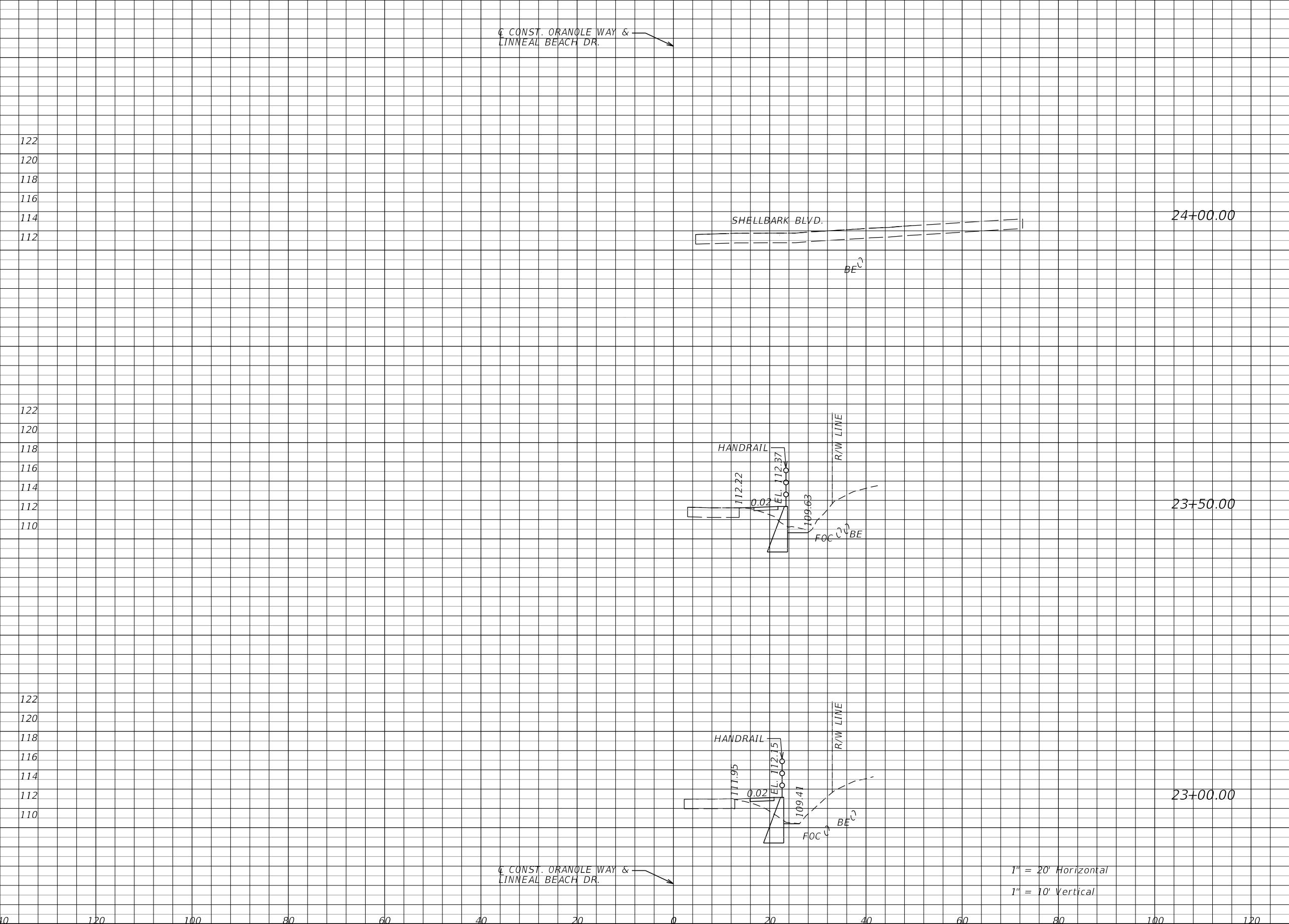

Regular		Exc.	Embankment	
A	V	A	V	
0.0	10	0.0	3	
11.2	19	3.3	8	
8.9	17	5.4	9	

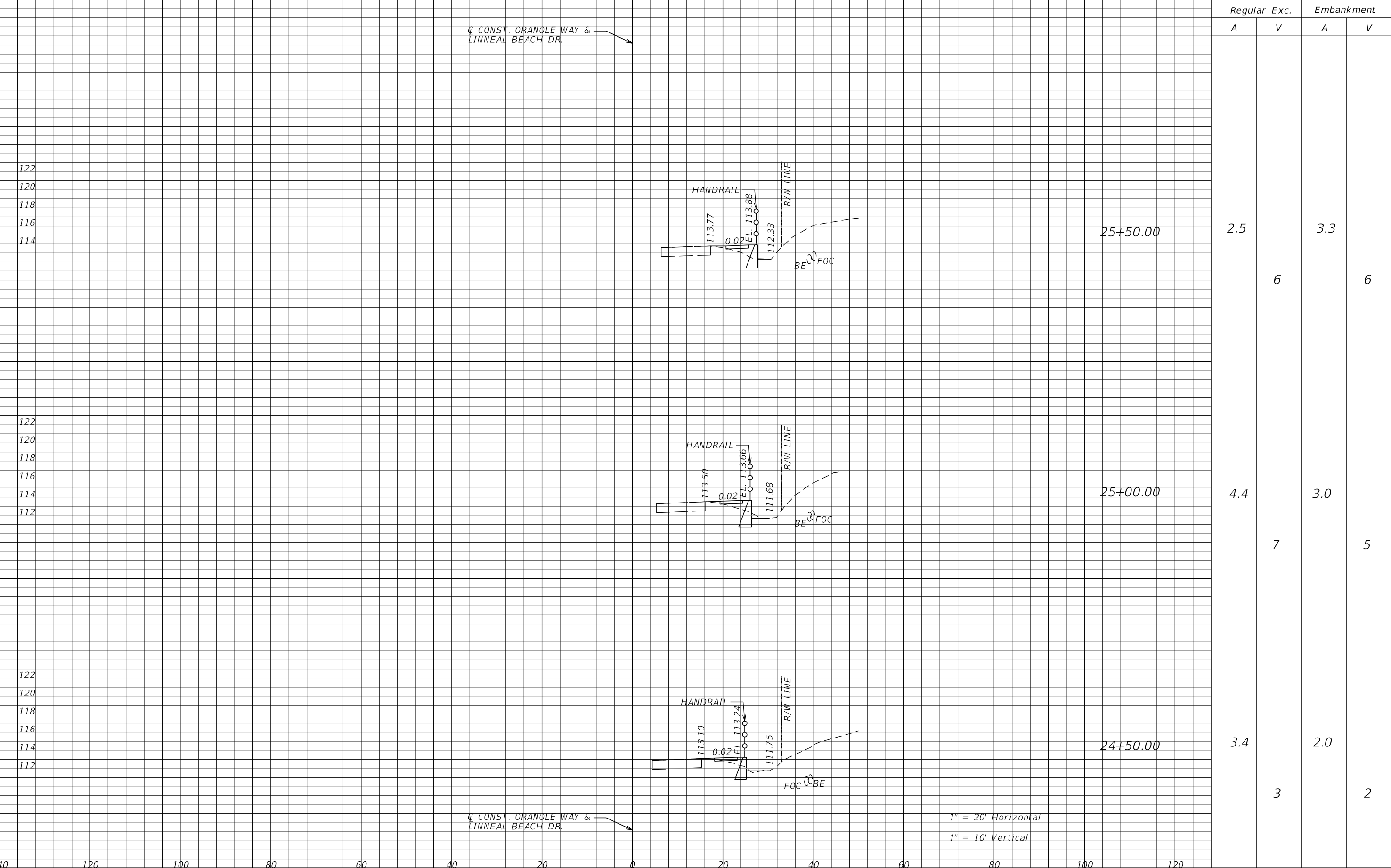

Regular		Exc.		Embankment	
A	V	A	V	A	V

2.5				3.3	
	6				6
4.4				3.0	
	7				5
3.4				2.0	
	3				2

1" = 20' Horizontal  
1" = 10' Vertical

REVISIONS				<div><b>SEMINOLE COUNTY</b> <small>FLORIDA'S NATURAL CHOICE</small></div>	<div><b>SEMINOLE COUNTY</b> <b>ENGINEERING DIVISION</b> DINO LUCARELLI P.E. No. 39556 100 East 1st. Street Sanford, Fl 32771</div>	<div><b>SEMINOLE COUNTY</b> <b>ENGINEERING DIVISION</b></div>		<div><b>CROSS-SECTIONS</b></div>	SHEET NO.
DATE	DESCRIPTION		DESCRIPTION			ROAD	COUNTY CIP No.		
							ORANOLE WAY & LINNEAL BEACH DR		02207081



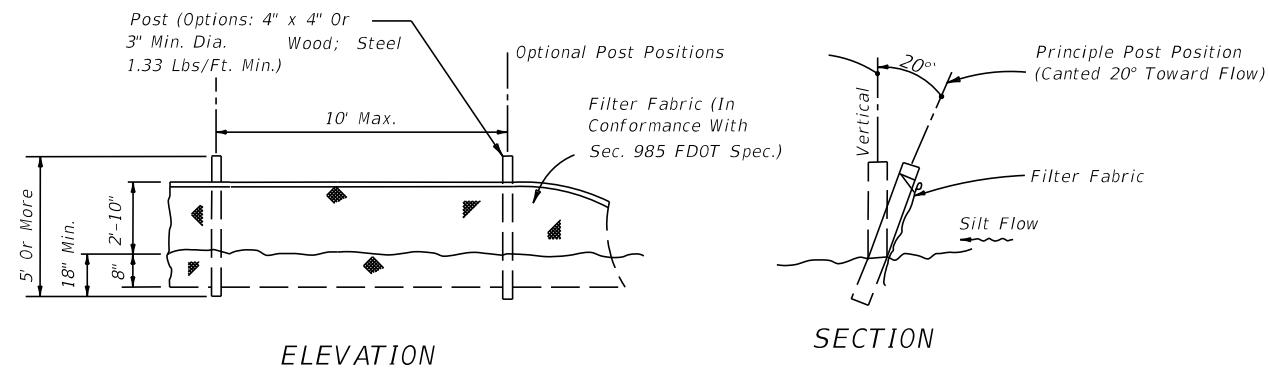

TYPE IV SILT FENCE

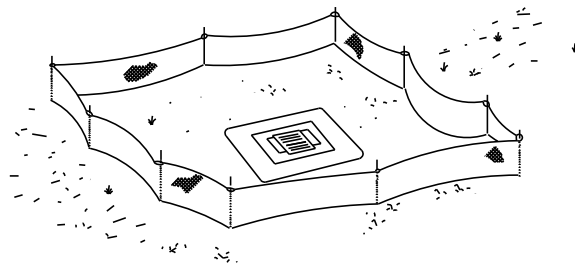

Type IV Silt Fence Protection  
Around Ditch Bottom Inlets.

Do not deploy in a manner that silt fences will act as a dam across permanent flowing watercourses. Silt fences are to be used at upland locations and turbidity barriers used at permanent bodies of water.

SILT FENCE APPLICATIONS

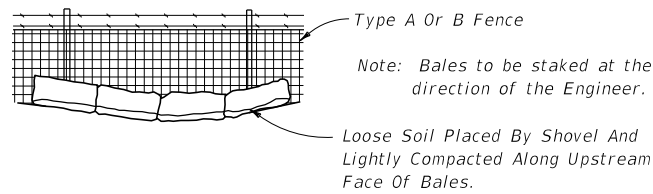

1. THE CONTRACTOR SHALL EXECUTE ALL MEASURES NECESSARY TO LIMIT THE TRANSPORT OF SEDIMENTS OUTSIDE THE LIMITS OF THE PROJECT TO THE VOLUME AND AMOUNT THAT ARE EXISTING PRIOR TO THE COMMENCEMENT OF CONSTRUCTION. THIS CONDITION WILL BE SATISFIED FOR THE TOTAL ANTICIPATED CONSTRUCTION PERIOD. PROVISION MUST BE MADE TO PRESERVE THE INTEGRITY AND CAPACITY OF CHECK WEIRS, SEDIMENT BASINS, SLOPE DRAINS, GRADING PATTERNS, ETC. REQUIRED TO MEET THIS PROVISION THROUGHOUT THE LIFE OF THE CONSTRUCTION. THE CONTRACTOR SHALL PROVIDE SYNTHETIC BALES, SILT BARRIERS, TEMPORARY GRASSING, ETC. AS REQUIRED TO FULLY COMPLY WITH THE INTENT OF THIS SPECIFICATION.
2. NO EXCAVATED MATERIAL SHALL BE STOCKPILED IN SUCH A MANNER AS TO DIRECT RUNOFF DIRECTLY OFF THE PROJECT SITE OR INTO ANY ADJACENT WATER BODY OR STORMWATER COLLECTION FACILITY.
3. THE SURFACE AREA OF OPEN, RAW ERODIBLE SOIL EXPOSED BY CLEARING AND GRUBBING OPERATIONS OR EXCAVATION AND FILLING OPERATIONS SHALL BE CONTROLLED, SO THAT THIS OPERATION WILL NOT SIGNIFICANTLY AFFECT OFF-SITE DEPOSIT OF SEDIMENTS.
4. INLETS AND CATCH BASINS SHALL BE PROTECTED FROM SEDIMENT LADEN STORMWATER RUNOFF UNTIL THE COMPLETION OF ALL CONSTRUCTION OPERATIONS THAT MAY CONTRIBUTE SEDIMENT TO THE INLET. (SEE NOTE 16).
5. AREAS OPENED BY CONSTRUCTION OPERATIONS THAT ARE NOT ANTICIPATED TO BE DRESSED OR RECEIVE FINAL GRASSING TREATMENT WITHIN THIRTY DAYS SHALL BE SEEDED WITH A QUICK GROWING GRASS SPECIES WHICH WILL PROVIDE AN EARLY COVER, DURING THE SEASON IN WHICH IT IS PLANTED. TEMPORARY SEEDING SHALL BE CONTROLLED SO AS TO NOT ALTER OR COMPETE WITH PERMANENT GRASSING. THE RATE OF SEEDING SHALL BE 30 POUNDS PER ACRE.
6. THE SEEDED OR SEEDED AND MULCHED AREA(S) SHALL BE ROLLED AND WATERED AS REQUIRED TO ASSURE OPTIMUM GROWING CONDITONS FOR THE ESTABLISHMENT OF A GOOD GRASS COVER.
7. IF AFTER 14 DAYS, THE TEMPORARY GRASSES AREAS HAVE NOT ATTAINED A MINIMUM OF 75% GOOD GRASS COVER, THE AREA WILL BE REWORKED AND ADDITIONAL SEED APPLIED TO ESTABLISH THE DESIRED VEGETATION COVER.
8. ALL FEATURES OF THE PROJECT SHALL BE CONSTRUCTED TO PREVENT EROSION AND SEDIMENT AND SHALL BE MAINTAINED DURING THE LIFE OF THE CONSTRUCTION SO AS TO FUNCTION PROPERLY WITHOUT THE TRANSPORT OF SEDIMENTS OUTSIDE THE LIMITS OF THE PROJECT.
9. ALL DISTURBED AREAS OUTSIDE THE EXCAVATION AND FILL LIMITS WILL BE RESTORED TO A CONDITION EQUAL TO OR BETTER THAN THEIR CONDITION PRIOR TO CONSTRUCTION.
10. THE CONTRACTOR WILL BE RESPONSIBLE FOR MAINTENANCE OF ALL NEWLY PLANTED GRASSES OR VEGETATION AND RETENTION/DETENTION FACILITIES UNTIL THE WORK HAS BEEN ACCEPTED BY THE COUNTY.
11. THE CONTRACTOR SHALL BE RESPONSIBLE FOR THE STABILITY OF EMBANKMENTS AND SHALL REPLACE ANY PORTION, WHICH IN THE OPINION OF THE ENGINEER, HAS BECOME DISPLACED DUE TO EROSION OR DUE TO CARELESSNESS OR NEGLIGENCE ON THE PART OF THE CONTRACTOR.
12. THE CONTRACTOR SHALL COMPLY WITH ALL FEDERAL, STATE, AND LOCAL LAWS AND REGULATIONS CONTROLLING POLLUTION OF THE ENVIRONMENT. MEASURES SHALL BE TAKEN BY THE CONTRACTOR TO CONTROL EROSION AND SEDIMENT RUNOFF FROM THE SITE DURING CONSTRUCTION. SUCH METHODS SHALL BE IN ACCORDANCE WITH THE CURRENT FLORIDA DEPARTMENT OF TRANSPORTATION STANDARDS.
13. ABSOLUTELY NO WORK WILL BE ALLOWED WITHIN ANY CONSERVATION AREA, BUFFER AREA, MITIGATION AREA OR DESIGNATED WETLAND AREA UNLESS SO SPECIFICALLY DESCRIBED BY THE PLANS AND GRANTED BY REASON OF PERMIT FROM THE GOVERNMENTAL ENTITY HAVING JURISDICTION OVER SAID AREA.
14. PRIOR TO CLEARING AND GRUBBING, THE LIMITS OF WETLANDS, BUFFERS, AND MITIGATION AREAS SHALL BE CLEARLY MARKED ALONG THE PROPOSED RIGHT OF WAY LINE TO PROTECT THESE AREAS FROM ENCROACHMENT FROM CONSTRUCTION ACTIVITIES.
15. ALL FILL EMBANKMENT AND GRADED AREAS SHALL BE PROTECTED AGAINST EROSION BY METHODS STATED IN "SECTION 104," F.D.O.T. STANDARD SPECIFICATIONS FOR BRIDGE AND ROAD CONSTRUCTION. SIDE SLOPE MAY BE SEEDED AND MULCHED, PROVIDED THAT THE MULCH MATERIAL IS DISC HARROWED AND THE SIDE SLOPES ARE NEITHER GREATER THAN 4:1 NOR PART OF A DRAINAGE CONVEYANCE.
16. EROSION CONTROL AT ALL INLET DRAINAGE STRUCTURES DURING CONSTRUCTION SHALL BE DONE IN ACCORDANCE WITH SECTION 104 PREVENTION, CONTROL AND ABATEMENT OF EROSION AND WATER POLLUTION.

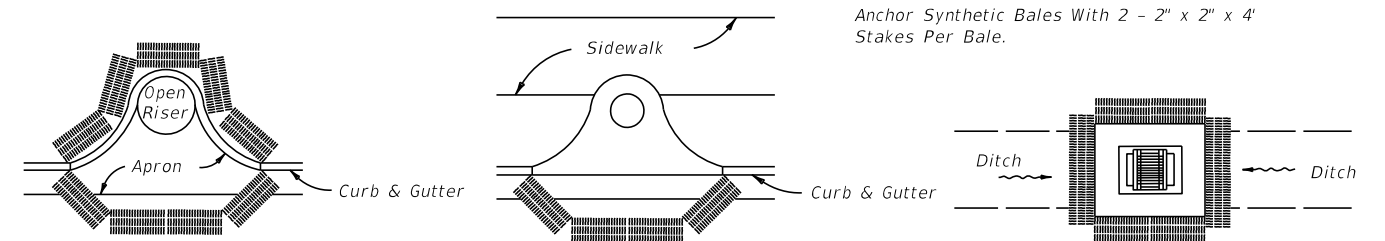

PARTIAL INLET COMPLETED INLET DITCH BOTTOM INLET

PROTECTION AROUND INLETS OR SIMILAR STRUCTURES

REVISIONS				 <b>SEMINOLE COUNTY</b> FLORIDA'S NATURAL CHOICE	<b>SEMINOLE COUNTY</b> <b>ENGINEERING DIVISION</b> DINO LUCARELLI P.E. No. 39556 100 East 1st. Street Sanford, FL 32771	<b>SEMINOLE COUNTY</b> <b>ENGINEERING DIVISION</b>		<b>STORMWATER POLLUTION</b> <b>PREVENTATION PLAN</b>	SHEET NO.
DATE	DESCRIPTION	DATE	DESCRIPTION			ROAD	COUNTY CIP No.		
						ORANOLE WAY & LINNEAL BEACH DR	02207081		26

SUMMARY OF LUMP SUM ITEMS					
PAY ITEM NO.	PAY ITEM DESCRIPTION	QUANTITY		DESIGN NOTES	CONSTRUCTION REMARKS
		P	F		
101 1	MOBILIZATION	1			

SUMMARY OF EROSION AND SEDIMENT CONTROL DEVICES						
LOCATION	SIDE	AREA ID	SEDIMENT BARRIER		DESIGN NOTES	CONSTRUCTION REMARKS
STA. TO STA.			0104 10 3			
			LF			
			P	F		
10+26.00 to 10+46.41	RT		20.4			
10+60.35 to 11+51.69	RT		91.3			
11+67.72 to 12+51.66	RT		83.9			
12+83.76 to 13+03.58	RT		19.8			
13+23.45 to 13+74.46	RT		51.0			
13+85.59 to 14+44.90	RT		59.3			
14+44.90 to 14+83.11	RT		40.8			
15+01.65 to 16+30.70	RT		137.9			
16+30.70 to 16+40.18	RT		10.1			
16+40.18 to 16+95.32	RT		32.3			
17+22.58 to 17+34.33	RT		10.6			
17+34.33 to 18+16.14	RT		87.1			
18+16.14 to 18+65.84	RT		50.4			
18+82.44 to 19+30.04	RT		47.6			
19+30.04 to 20+06.71	RT		50.7			
20+06.71 to 20+69.05	RT		65.7			
20+68.97 to 21+67.09	RT		103.4			
21+67.09 to 21+80.42	RT		14.1			
21+80.42 to 23+82.41	RT		214.6			
24+26.80 to 25+66.10	RT		148.3			
25+66.10 to 27+01.67	RT		136.2			
SUB-TOTAL :			1475.5			
TOTAL :			1476			

REVISIONS				<div><div>SEMINOLE COUNTY FLORIDA'S NATURAL CHOICE</div></div> <div><div>SEMINOLE COUNTY ENGINEERING DIVISION</div><div>DINO LUCARELLI P.E. No. 39556 100 East 1st. Street Sanford, FL 32771</div></div>	SEMINOLE COUNTY ENGINEERING DIVISION		SUMMARY OF QUANTITIES	SHEET NO.
DATE	DESCRIPTION	DATE	DESCRIPTION		ROAD	COUNTY CIP No.		SQ-1
					ORANOLE WAY & LINNEAL BEACH DR	02207081		

SUMMARY OF CLEARING AND GRUBBING & REMOVAL ITEMS														
PAY ITEM NO.	PAY ITEM DESCRIPTION	LOCATION	SIDE	AREA ID	LENGTH	WIDTH	UNITS	SECONDARY UNITS (IF LUMP SUM)	QUANTITY		TOTAL		DESIGN NOTES	CONSTRUCTION REMARKS
		STA. TO STA.						AREA (AC)	P	F	P	F		
0110 4 10	REMOVAL OF EXISTING CONCRETE	10+53.27	RT				SY		19.2		163			
		11+59.74	RT				SY		16.5					
		12+68.21	RT				SY		29.1					
		13+13.63	RT				SY		21.6					
		13+79.95	RT				SY		12.0					
		14+92.72	RT				SY		22.1					
		17+10.09	RT				SY		17.0					
		18+74.68	RT				SY		19.4					
		27+15.27	RT				SY		6.5					

SUMMARY OF MAILBOXES					
STATION	SIDE	QUANTITY		DESIGN NOTES	CONSTRUCTION REMARKS
		0110	7 1		
		P	F		
13+89.05	RT	1		RELOCATE	
17+27.11	RT	1		RELOCATE	
SUB-TOTAL :		2			
TOTAL :		2			

SUMMARY OF EARTHWORK					
PAY ITEM NO.	PAY ITEM DESCRIPTION	CY		DESIGN NOTES	CONSTRUCTION REMARKS
		P	F		
120-1	REGULAR EXCAVATION				
	ORANOLE WAY & LINNEAL BEACH DR.	329.86			
120-6	EMBANKMENT (FILL)				
	ORANOLE WAY & LINNEAL BEACH DR.	129.82			

SUMMARY OF WALLS											
WALL NO.	PAY ITEM NO.	PAY ITEM DESCRIPTION	LOCATION	SIDE	UNIT	QUANTITY		TOTAL		DESIGN NOTES	CONSTRUCTION REMARKS
			STA. TO STA.			P	F	P	F		
1	400 0 11	CONCRETE CLASS NS, GRAVITY WALL	21+24.26 TO 23+66.09	RT	CY	31.2		66			
2		INDEX 400-011	24+35.11 TO 27+05.92	RT	CY	34.3					

REVISIONS				 <b>SEMINOLE COUNTY</b> <small>FLORIDA'S NATURAL CHOICE</small>	<b>SEMINOLE COUNTY</b> <u><b>ENGINEERING DIVISION</b></u>  DINO LUCARELLI P.E. No. 39556 100 East 1st. Street Sanford, FL 32771	<b>SEMINOLE COUNTY</b> <b>ENGINEERING DIVISION</b>		<i>SUMMARY OF QUANTITIES</i>	SHEET NO.
DATE	DESCRIPTION	DATE	DESCRIPTION			ROAD	COUNTY CIP No.		SQ-2
						ORANOLE WAY & LINNEAL BEACH DR	02207081		

SUMMARY OF SIDE DRAIN & MITERED END SECTIONS							
LOCATION	SIDE	PIPE LENGTH - LF		MES - EA		DESIGN NOTES	CONSTRUCTION REMARKS
		ROUND (0430174118)		ROUND (0430984125)			
18" RCP		18" RCP					
STA. TO STA.		P	F	P	F		
20+01.92	RT	6.1		1			
SUB-TOTAL :		6.1		1			
TOTAL :		6		1			

SUMMARY OF RAILING					
LOCATION	SIDE	PIPE HANDRAIL - GUIDERAIL		DESIGN NOTES	CONSTRUCTION REMARKS
		0515 1 2			
		LF			
STA. TO STA.		P	F		
21+25.00 TO 23+67.00	RT	253.0			
24+35.00 TO 27+05.00	RT	278.0			
TOTAL :		531			

SUMMARY OF CURB & GUTTER AND/OR TRAFFIC SEPARATORS													
PAY ITEM NO.	PAY ITEM DESCRIPTION	LOCATION	SIDE	AREA ID	UNIT	QUANTITY					TOTAL		DESIGN NOTES
		STA. TO STA.				GROSS LENGTH	DEDUCTIONS TYPE	LENGTH	NET LENGTH P	F	P	F	
520 1 10	CONCRETE CURB & GUTTER, TYPE F	27+02.49 TO 27+24.10	RT	6346	LF	30.1	CR	8.7			21		CURB RAMP

REVISIONS				 <div>SEMINOLE COUNTY FLORIDA'S NATURAL CHOICE</div>	SEMINOLE COUNTY ENGINEERING DIVISION DINO LUCARELLI P.E. No. 39556 100 East 1st. Street Sanford, FL 32771	SEMINOLE COUNTY ENGINEERING DIVISION		SUMMARY OF QUANTITIES	SHEET NO.
DATE	DESCRIPTION	DATE	DESCRIPTION			ROAD	COUNTY CIP No.		SQ-3
						ORANOLE WAY & LINNEAL BEACH DR	02207081		



SUMMARY OF SIDEWALK & DETECTABLE WARNINGS												
LOCATION	SIDE	AREA ID	LENGTH	WIDTH	CONC SIDEWALK 4"		CONC SIDEWALK 6"		DETECTABLE WARNINGS		DESIGN NOTES	CONSTRUCTION REMARKS
STA. TO STA.					0522 1		0522 2		0527 2			
					SY		SY		SF			
					P	F	P	F	P	F		
10+19.26 TO 10+44.91	RT	8077	25.7	5.0	14.2							
10+40.91 TO 10+65.33	RT	8208	24.4	8.1			17.1					
10+61.33 TO 11+51.17	RT	8085	89.8	5.0	49.8							
11+47.17 TO 11+72.23	RT	8223	25.1	8.1			17.5					
11+68.23 TO 12+51.60	RT	8092	83.4	5.0	46.2							
12+47.60 TO 12+85.23	RT	8232	37.6	7.9			30.0					
12+84.07 TO 13+02.60	RT	8099	18.5	5.0	10.2							
12+98.60 TO 13+28.44	RT	8239	29.8	7.8			21.0					
13+24.44 TO 13+73.90	RT	8107	49.5	5.0	27.3							
13+69.90 TO 13+90.07	RT	8247	20.2	8.0			13.0					
13+86.07 TO 14+83.13	RT	8114	97.1	5.0	54.9							
14+79.26 TO 15+05.66	RT	8282	26.4	8.5			20.7					
15+01.81 TO 16+97.07	RT	8123	195.3	5.0	101.9							
16+91.14 TO 17+26.01	RT	8262	34.9	8.3			18.8					
17+22.89 TO 18+64.32	RT	8134	141.4	5.0	80.6							
18+60.32 TO 18+87.66	RT	8263	27.3	8.0			19.4					
18+83.66 TO 23+81.54	RT	8147	497.9	5.0	273.8							
23+74.49 TO 23+81.54	RT	8205	7.1	2.0					13.9			
24+26.92 TO 24+34.85	RT	8206	7.9	2.0					15.1			
24+26.92 TO 27+15.29	RT	8164	288.4	5.0	159.5							
27+08.54 TO 27+15.29	RT	8207	6.8	2.0					12.4			
TOTAL :					818		158		41			

REVISIONS				 SEMINOLE COUNTY FLORIDA'S NATURAL CHOICE	DINO LUCARELLI P.E. No. 39556 100 East 1st. Street Sanford, FL 32771	SEMINOLE COUNTY ENGINEERING DIVISION		SUMMARY OF QUANTITIES	SHEET NO.		
DATE	DESCRIPTION	DATE	DESCRIPTION			SEMINOLE COUNTY ENGINEERING DIVISION			ROAD	COUNTY CIP No.	SQ-4
						ORANOLE WAY & LINNEAL BEACH DR	02207081				

SUMMARY OF PERFORMANCE TURF								
LOCATION	SIDE	AREA ID	LENGTH	WIDTH	PERFORMANCE TURF (SOD)		DESIGN NOTES	CONSTRUCTION REMARKS
					570 1 2			
SY								
P					F			
STA. TO STA.								
10+19.26 TO 10+43.63	RT	6719	24.4	0.0 - 5.3	8.5			
10+19.26 TO 10+46.65	RT	6720	27.4	0.0 - 3.6	9.7			
10+60.18 TO 11+51.78	RT	6722	91.6	0.0 - 3.7	36.7			
10+62.62 TO 11+49.85	RT	6721	87.2	0.0 - 3.1	28.6			
11+67.61 TO 12+51.65	RT	6723	84.0	0.0 - 3.7	34.8			
11+69.52 TO 12+50.27	RT	6724	80.8	0.0 - 3.1	26.3			
12+83.64 TO 13+03.56	RT	6725	19.9	0.0 - 3.8	8.2			
12+84.48 TO 13+01.16	RT	6726	16.7	0.0 - 2.8	4.5			
13+23.43 TO 13+74.60	RT	6727	51.2	0.0 - 3.9	21.7			
13+25.88 TO 13+72.56	RT	6782	46.7	0.0 - 3.0	13.8			
13+85.42 TO 14+83.16	RT	6735	97.7	0.0 - 4.0	44.0			
13+87.40 TO 14+81.94	RT	6768	94.5	0.0 - 3.3	32.0			
15+01.63 TO 16+97.29	RT	6743	195.7	4.0 - 8.0	86.7			
15+02.99 TO 16+94.83	RT	6753	191.8	0.0 - 4.3	64.1			
17+23.71 TO 18+62.86	RT	6891	139.2	0.0 - 3.3	45.9			
17+25.51 TO 18+66.31	RT	6790	140.8	0.0 - 12.6	209.5			
18+82.30 TO 23+82.29	RT	6804	500.0	8.0 - 17.8	532.5			
18+84.87 TO 23+75.35	RT	6893	490.5	0.0 - 5.3	179.7			
24+25.69 TO 27+23.04	RT	6805	297.4	4.0 - 8.6	159.4			
24+34.06 TO 27+08.54	RT	6806	274.5	0.0 - 3.7	93.6			
TOTAL :					1640			

SUMMARY OF SIGNING & PAVEMENT MARKINGS										
PAY ITEM NO.	PAY ITEM DESCRIPTION	LOCATION	SIDE	UNIT	QUANTITY		TOTAL		DESIGN NOTES	CONSTRUCTION REMARKS
		STA. TO STA.			P	F	P	F		
700 1 50	SINGLE POST SIGN, RELOCATE	10+70.09	RT	AS	1.0		7		16.92' RT TO 14.81' RT	
		11+36.39	RT		1.0				17.97' RT TO 14.79' RT	
		16+40.09	RT		1.0				16.22' RT TO 14.39' RT	
		17+91.40	RT		1.0				14.62' RT TO 14.01' RT	
		18+50.66	RT		1.0				13.68' RT TO 13.23' RT	
		20+26.46	RT		1.0				10.98' RT TO 9.06' RT	
		21+80.21	RT		1.0				12.89' RT TO 10.71' RT	
711 11 125	THERMOPLASTIC, STANDARD, WHITE, SOLID,	23+74.04 TO 24+35.45	RT	LF	62.7		222		CROSSWALK	
	24" FOR STOP LINE AND CROSSWALK	23+82.30 TO 24+25.82	RT		44.7				CROSSWALK	
		24+04.74 TO 24+17.83	RT		13.8				STOP BAR	
		27+10.99 TO 27+63.92	RT		52.9				CROSSWALK	
		27+19.88 TO 27+55.41	RT		35.5				CROSSWALK	
		27+38.44 TO 27+51.26	RT		12.8				STOP BAR	

REVISIONS				<div><div>SEMINOLE COUNTY ENGINEERING DIVISION</div><div>DINO LUCARELLI P.E. No. 39556 100 East 1st. Street Sanford, FL 32771</div></div>	SEMINOLE COUNTY ENGINEERING DIVISION		SUMMARY OF QUANTITIES	SHEET NO.
DATE	DESCRIPTION	DATE	DESCRIPTION		ROAD	COUNTY CIP No.		SQ-5
					ORANOLE WAY & LINNEAL BEACH DR	02207081		